

IT-36CIID



FEATURES

- Rigorously tested to ensure decades of use
- Exceptional support from Madison, WI-based Customer Care team
- Ready to be fitted with custom panels and handles to blend with cabinetry
- Over-and-under refrigerator/freezer storage
- Dual refrigeration keeps food fresher longer
- Automatic ice maker with "max ice" feature
- Air purification system fights spoilage, odors
- Internal water dispenser works with seamless design
- Water-filtration system reduces contaminants, chlorine taste and odor

ACCESSORIES

- Air Purification Cartridge
- Dual Installation Kit Handle to Handle
- Dual Installation Kit Hinge to Handle
- Dual Installation Kit Hinge to Hinge
- Egg Container
- Reduced Toekick Divider
- Stainless Steel Side Panel
- Stainless Steel Top Panel
- Water Filter 4204490
- Stainless Steel Tubular Handles
- Stainless Steel Pro Handles

Accessories are available through an authorized dealer.
For local dealer information, visit subzero-wolf.com/locator.



HANDLE ACCESSORIES

PRO



TUBULAR



PRODUCT DETAILS

REFRIGERATOR

- Three adjustable glass shelves
- One stationary shelf
- Crisper drawer with two adjustable dividers
- Adjustable dairy compartment
- Two adjustable door shelves
- One stationary door shelf

FREEZER

- Three adjustable drawer dividers
- Removable ice container
- Automatic ice maker

PRODUCT SPECIFICATIONS

| | |
|-----------------------|--------------------------|
| Model | IT-36CIID |
| Dimensions | 36"W x 84"H x 24"D |
| Door Clearance | 34 1/2" |
| Drawer Clearance | 18 3/8" |
| Weight | 460 lbs |
| Refrigerator Capacity | 13.3 cu. ft. |
| Freezer Capacity | 6.4 cu. ft. |
| Electrical Supply | 115 VAC, 60 Hz |
| Electrical Service | 15 amp dedicated circuit |
| Receptacle | 3-prong grounding-type |

DIMENSIONS

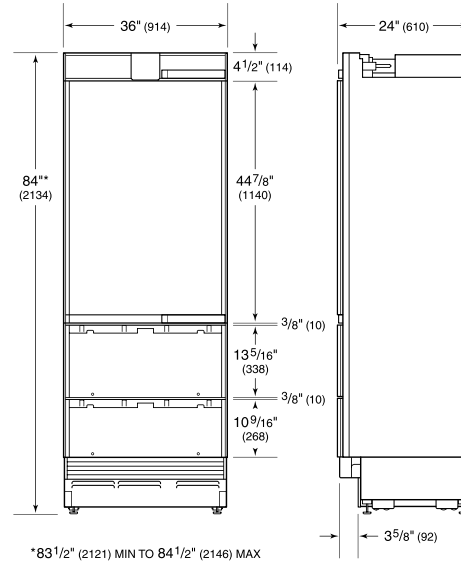

ELECTRICAL

PLUMBING

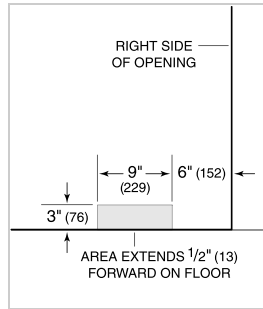
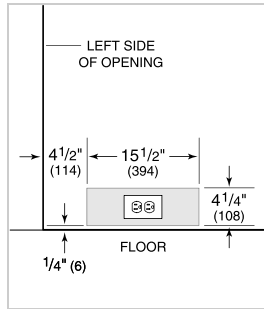

PANEL SPECIFICATIONS For complete panels specifications including width/height, weight requirements and thickness requirements visit subzero-wolf.com/reveal.

NOTE: Dimensions in parenthesis are in millimeters unless otherwise specified

INTERIOR VIEW

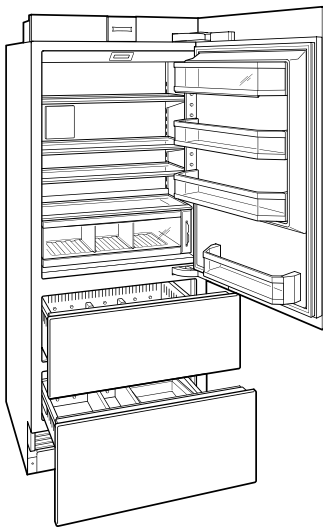

This illustration is intended for interior reference only and may not represent the exterior of the model being specified.

STANDARD INSTALLATION

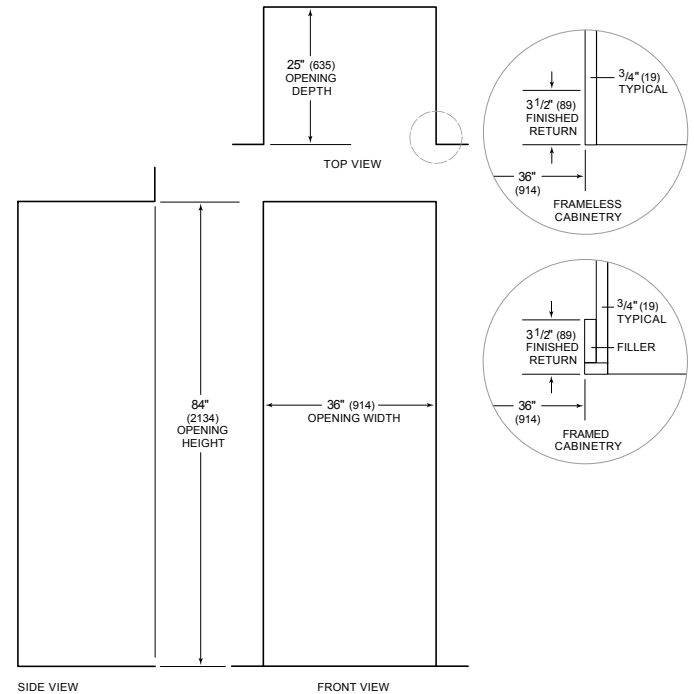

NOTE: 3 1/2" (89) finished returns will be visible and should be finished to match cabinetry