

42"/36" LOW PROFILE ISLAND-MOUNT CANOPY HOODS

JXI8742DS – 36" x 30<sup>3</sup>/<sub>8</sub>"-47<sup>5</sup>/<sub>8</sub>" x 24

JXI8736DS – 42" x 30<sup>3</sup>/<sub>8</sub>"-47<sup>5</sup>/<sub>8</sub>" x 24

PRODUCT DIMENSIONS

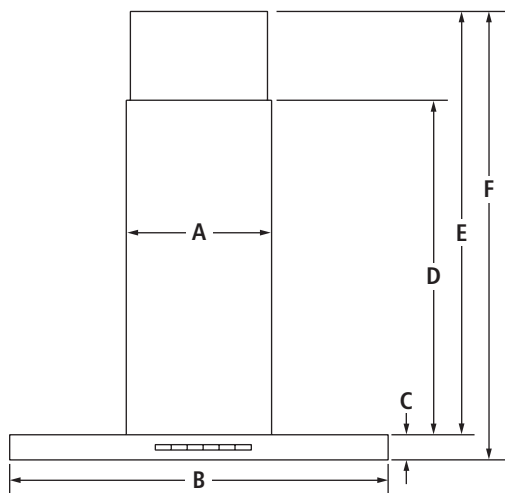

FRONT VIEW

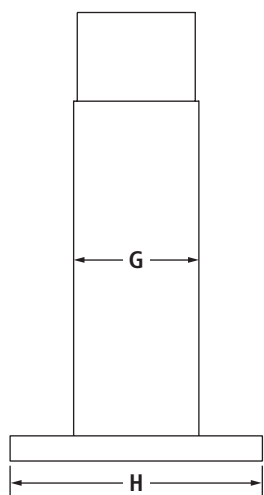

SIDE VIEW

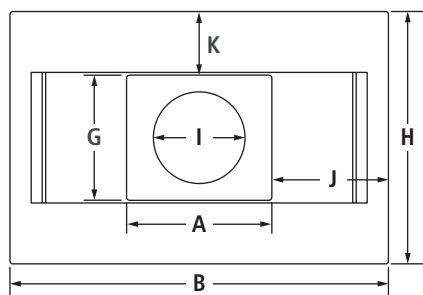

TOP VIEW

MODEL #		JXI8742DS		JXI8736DS	
		in	cm	in	cm
A	Width of chimney	13	33.0	13	33.0
B	Width of hood	42	106.7	36	91.4
C	Height of hood	2 <sup>3</sup> / <sub>8</sub>	6.0	2 <sup>3</sup> / <sub>8</sub>	6.0
D	Height of chimney	21 <sup>3</sup> / <sub>4</sub>	55.2	21 <sup>3</sup> / <sub>4</sub>	55.2
E	Overall height of chimney with extension	28-45 <sup>1</sup> / <sub>4</sub>	71.0-115.0	28-45 <sup>1</sup> / <sub>4</sub>	71.0-115.0
F	Overall height with vented installation (min.-max.)	30 <sup>3</sup> / <sub>8</sub> -47 <sup>5</sup> / <sub>8</sub>	77.2-120.1	30 <sup>3</sup> / <sub>8</sub> -47 <sup>5</sup> / <sub>8</sub>	77.2-120.1
G	Depth of chimney	11 <sup>1</sup> / <sub>4</sub>	28.6	11 <sup>1</sup> / <sub>4</sub>	28.6
H	Depth of hood	24	61.0	24	61.0
I	Vent collar diameter	6	15.2	6	15.2
J	Width from chimney to edge of hood	14 <sup>1</sup> / <sub>2</sub>	36.8	11 <sup>1</sup> / <sub>2</sub>	29.2
K	Depth from chimney to back edge of hood	6 <sup>3</sup> / <sub>8</sub>	16.2	6 <sup>3</sup> / <sub>8</sub>	16.2

**IMPORTANT:** Dimensional specifications are provided for planning purposes only. Do not make any cutouts based on this information. Refer to the Installation or Use & Care Guide before selecting cabinetry, verifying electrical/gas connections, making cutouts or beginning installation. All Jenn-Air® appliances are appropriately UL, CUL or CSA approved.

42"/36" LOW PROFILE ISLAND-MOUNT CANOPY HOODS

JXI8742DS – 36" x 30<sup>3</sup>/<sub>8</sub>"-47<sup>5</sup>/<sub>8</sub>" x 24

JXI8736DS – 42" x 30<sup>3</sup>/<sub>8</sub>"-47<sup>5</sup>/<sub>8</sub>" x 24

OPENING/CLEARANCE DIMENSIONS

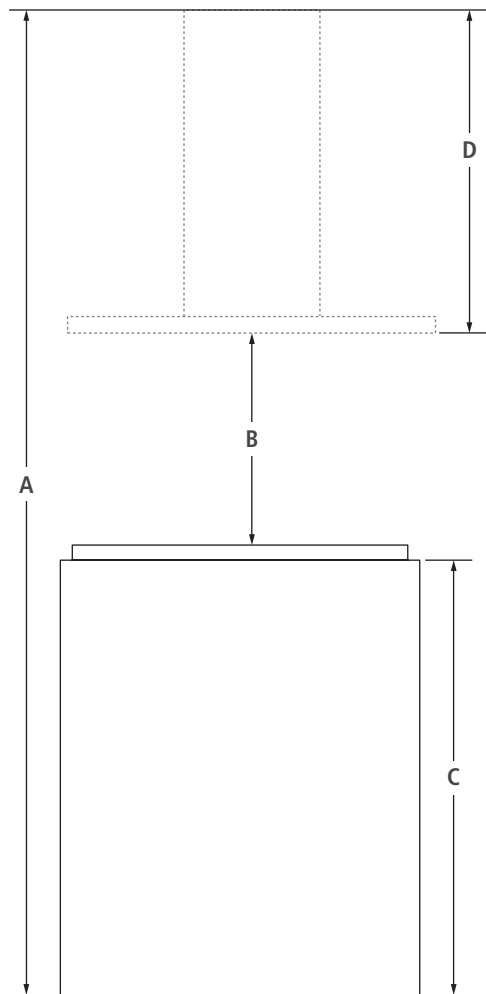

FRONT VIEW

MODEL #		JXI8942DS		JXI8936DS	
		in	cm	in	cm
A	Ceiling height	—	—	—	—
	Suggested distance from hood to electric cooking surface (min.-max.)	24-36	61.0-91.4	24-36	61.0-91.4
B	Suggested distance from hood to gas cooking surface (min.-max.)	30-36	76.2-91.4	30-36	76.2-91.4
	Countertop height	—	—	—	—
D	Height from bottom of hood to ceiling (A – B – C = D)	—	—	—	—

**ELECTRICAL REQUIREMENTS**

120 volt, 60 Hz, AC only, 15-amp fused, electrical circuit is required.

**VENTING REQUIREMENTS**

The hood is factory set for venting through the roof. For non-vented (recirculating) installation, refer to recirculation kit instructions for further information.

**LOCATION REQUIREMENTS**

Ceiling structure must be able to support 100 lb (45.4 kg).

For vented installation, the chimney can be adjusted for ceilings between 7' 6" (2.29 m) and 10' (3.04 m).

For non-vented (recirculating) installation, the chimney can be adjusted for ceilings between 7' 6" (2.29 m) and 10' (3.04 m).

**IMPORTANT:** Dimensional specifications are provided for planning purposes only. Do not make any cutouts based on this information. Refer to the Installation or Use & Care Guide before selecting cabinetry, verifying electrical/gas connections, making cutouts or beginning installation. All Jenn-Air® appliances are appropriately UL, CUL or CSA approved.