

IT-36RID



## FEATURES

- All-refrigerator storage solves capacity problems
- Air purification system fights spoilage, odors
- Internal water dispenser works with seamless design
- Water-filtration system reduces contaminants, chlorine taste and odor
- Crispers and deli drawers in low-temp, high-humidity zones for optimum freshness
- Ready to be fitted with custom panels and handles to blend with cabinetry
- Nano-coated spill-proof shelves for easy clean-up
- Rigorously tested in our U.S. manufacturing facilities to ensure decades of use
- Exceptional 24/7 support from Madison, WI-based Customer Care team
- Soft-close doors and drawers

## ACCESSORIES

- Air Purification Cartridge
- Egg Container
- Stainless steel tubular handles
- Stainless steel pro handles
- Dual installation kits
- Stainless steel front panels with tubular or pro handles
- Stainless steel kickplate
- Stainless steel side enclosure
- Stainless steel top enclosure
- Reduced toe kick divider for toe kicks from 2" to 3.875"
- Replacement water filter

Accessories are available through an authorized Sub-Zero dealer.  
For local dealer information, visit [subzero-wolf.com/locator](http://subzero-wolf.com/locator).



## HANDLE ACCESSORIES

PRO



TUBULAR



## PRODUCT DETAILS

### REFRIGERATOR

- Three adjustable glass shelves
- One stationary shelf
- Deli drawer with two adjustable dividers
- Adjustable dairy compartment
- Two adjustable door shelves
- One stationary door shelf
- Sliding crisper drawer cover
- Four adjustable drawer dividers

# 36" INTEGRATED OVER-AND-UNDER REFRIGERATOR INTERNAL DISPENSER - PANEL READY



## PRODUCT SPECIFICATIONS

|                       |                          |
|-----------------------|--------------------------|
| Model                 | IT-36RID                 |
| Dimensions            | 36"W x 84"H x 24"D       |
| Door Clearance        | 34 1/2"                  |
| Drawer Clearance      | 18 3/8"                  |
| Weight                | 460 lb                   |
| Refrigerator Capacity | 20.5 cu ft               |
| Electrical Supply     | 115 VAC, 60 Hz           |
| Electrical Service    | 15 amp dedicated circuit |
| Receptacle            | 3-prong grounding-type   |

## ELECTRICAL

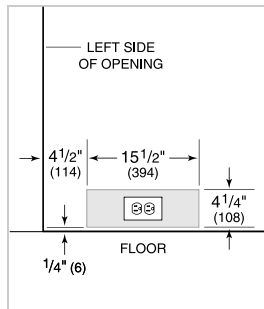

## PLUMBING

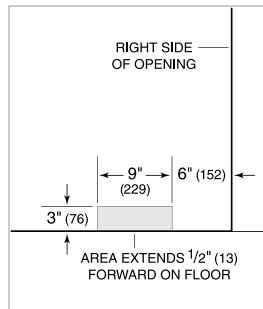

## INTERIOR VIEW

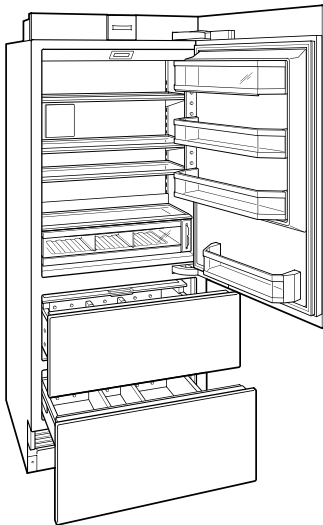

This illustration is intended for interior reference only and may not represent the exterior of the model being specified.

## DIMENSIONS

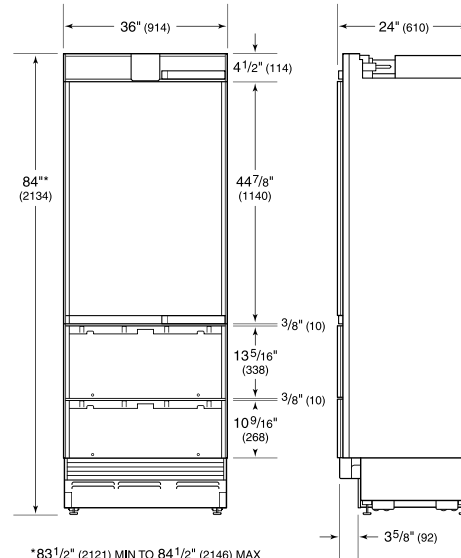

\*83 1/2" (2121) MIN TO 84 1/2" (2146) MAX

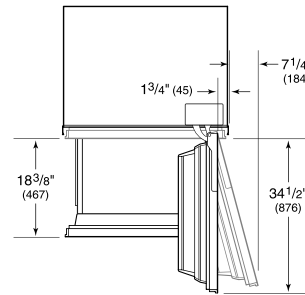

## STANDARD INSTALLATION

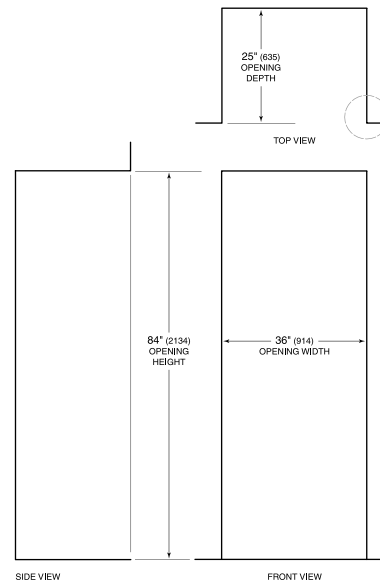

SIDE VIEW

FRONT VIEW

NOTE: 3/2" (89) finished returns will be visible and should be finished to match cabinetry.

