

# GLIDE-24-2

## 24" Built-In Glide-Out Range Hood



### Signature Features

#### Glide Out Hood

The glide out hood extends during use, and neatly tucks away when not needed.

#### Two Speed Adjustments

Provides power level options to suit your cooking style.

#### LED Lighting Strip

LED lights illuminate the cooktop, increase visibility, and are more energy efficient.

### General Properties

- Slide-Out Hood - Powder Coating Dark Gray
- Duct Mode
- Stainless Steel Handle (Can be replaced with matching cabinetry)
- Rocker Switch – Light Switch on Right Side, Fan Switch on Left Side
- 2 x Rectangle LED Lights with Smog Cover - Color Temp: 3,200K
- 2 x Honeycomb Filters
- 6" Metallic Outer Adapter



### Features

- 2 x Speed Adjustment
- AC Capacitor Motor
- Motor Power: 130 W
- Total Power: 132 W
- 300 CFM / 65 dBa
- 6" Metallic Outer Adapter

### Handle Replacement Dimensions

- Width: 23<sup>9</sup>/<sub>16</sub>" (598mm)
- Height: 1<sup>9</sup>/<sub>16</sub>" (40mm)

### Technical Specifications

#### Product Dimensions (W/H/D)

- 23<sup>9</sup>/<sub>16</sub>" / 8<sup>5</sup>/<sub>16</sub>" / 11<sup>1</sup>/<sub>16</sub>"
- 598mm / 211mm / 281mm

#### Cut Out Dimensions (W/H/D)

- min. 23<sup>5</sup>/<sub>8</sub>"-max. 24" / 8<sup>3</sup>/<sub>4</sub>" / min. 12"
- min. 600- max. 610mm / 222mm / 305mm

#### Weight

- Net Weight – 7.1kg (15 lbs.)
- Gross Weight – 8.2kg (18 lbs.)

#### Electrical Requirements

- 120 V / 60 Hz
- Supplied with a Canadian plug and 1m long cord.





# GLIDE-24-2

## Specifications



### Recommended Cabinet Minimum Clearance (Gas Cooktop)

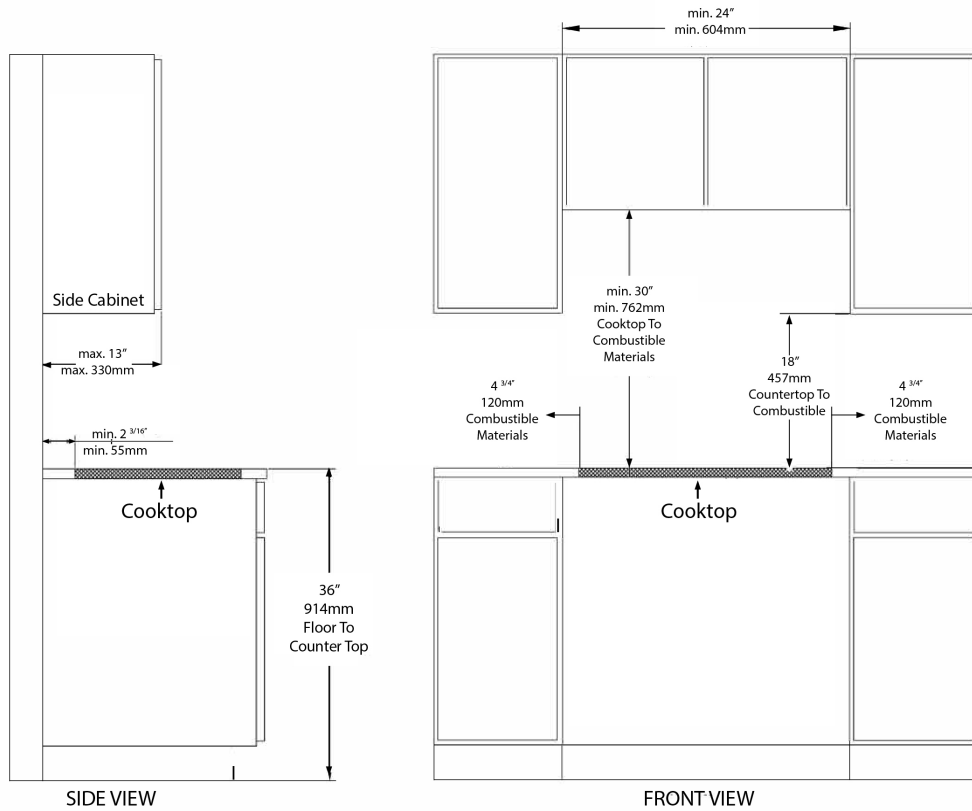

### Recommended Cabinet Minimum Clearance (Electric & Induction Cooktops)

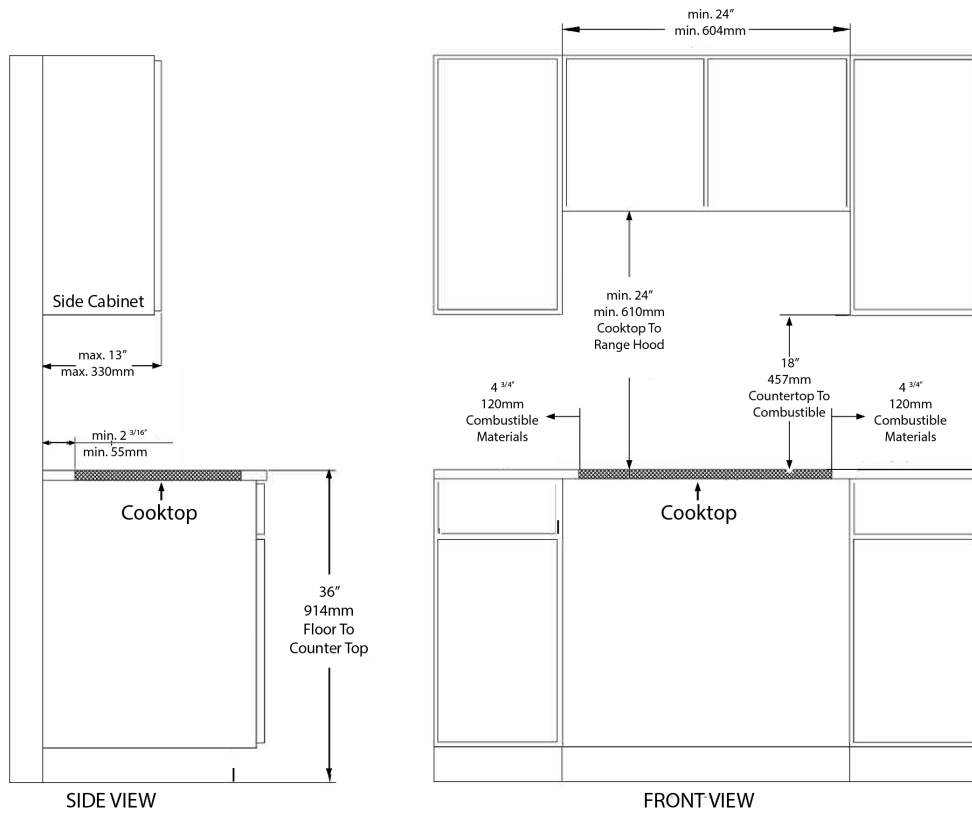

Other Product Downloads Available at [porterandcharles.ca](http://porterandcharles.ca)

- [Download User Manual](#)



#### WARRANTY INFORMATION

Porter & Charles Appliances are designed and manufactured to the highest standards. Each appliance is covered by a comprehensive 2-year parts and labour warranty. Refer to product warranty policy for complete terms and conditions.

#### FOR PARTS & SERVICE

Euro-Parts & Service  
39822 Belgrave Road, Belgrave, ON. N0G 1E0 1 866 722 2262  
[www.euro-parts.ca](http://www.euro-parts.ca) • [parts@euro-parts.ca](mailto:parts@euro-parts.ca) • [service@euro-parts.ca](mailto:service@euro-parts.ca)

Porter & Charles appliances are imported and distributed in North America by Euro-Line Appliances Inc. For more information, please visit one of our showrooms or [www.ela.ca](http://www.ela.ca) / [www.elawest.ca](http://www.elawest.ca)

#### EURO-LINE APPLIANCES INC.

871 Cranberry Court, Oakville, ON  
L6L 6J7 Canada  
905 829 3980  
1 800 421 6332  
[info@ela.ca](mailto:info@ela.ca)

#### EURO-LINE APPLIANCES INC.

101-1014 Homer Street, Vancouver, BC  
V6B 2W9, Canada  
604 235 3980  
1 855 ELA WEST (352 9378)  
[info@elawest.ca](mailto:info@elawest.ca)