

36" Bottom Mount French Door Refrigerator

KFNF 9955 iDE



36" Bottom Mount French Door Refrigerator KFNF 9955 iDE



KFN9 9955 iDE

Features:

- NEW: Miele PerfectCool Series
- French Door
- Plumbed IceMaker
- Soft Close Door
- Gallon Door Bin
- Comfort Clean Door Bin
- Double Freezer Drawers
- PerfectFresh
- Energy Star
- Sabbath Mode

SPECIFICATIONS

KFN9 9955 iDE — Item 38995500USA

Overall Unit Width 35¹³/₁₆" (910mm)

Overall Unit Height 79¹³/₁₆" (2027mm)

Overall Unit Depth 24" (610mm)

Niche

Cabinet Opening Width 36" (915mm)

Minimum Cabinet Opening Height 80" (2032mm)

Minimum Cabinet Opening Depth ≥ 24" (610mm)

Plumbing

Water Supply Requirements Connect to a cold water supply only. Must be connected to a shut-off valve. The water shut-off valve must be accessible after installation. The water pressure must be between 22 psi (1.5 bar) and may not exceed 87 psi (6 bar). If the pressure is higher than 87 psi (6 bar), a pressure reducing valve must be installed.

Water Connection Line Use 1/4" OD copper line. This is NOT supplied with the appliance.

Electrical

Electrical Requirements - Volts/Amps 110V / 120V, 60Hz, 15 Amps (single)
110V / 120V, 60Hz, 20Amp (side-by-side)

Power Cord - Plug and length NEMA 5-15 plug, 7' 10¹/₂" (2.4m)

Ventilation

Additional cutout Not Required

Custom Panel

Maximum Panel Weight Top Panels - 26¹/₂ lbs (12 kg)
Middle Panel - 26¹/₂ lbs (12 kg)
Bottom Panel - 26¹/₂ lbs (12 kg)

Maximum Panel Thickness 3/4" (19mm)

Minimum Panel Thickness 5/8" (16mm)

Shipping

Shipping Weight 383.5 lbs (174 kg)

Shipping Dimensions 38¹/₁₆" W x 83⁵/₈" H x 29¹/₂" D

Support

Call Miele 800.843.7231

Miele Website www.mieleusa.com

20/20 Link 2020technologies.com

36" Bottom Mount French Door Refrigerator KFNF 9955 iDE



Unit Dimension

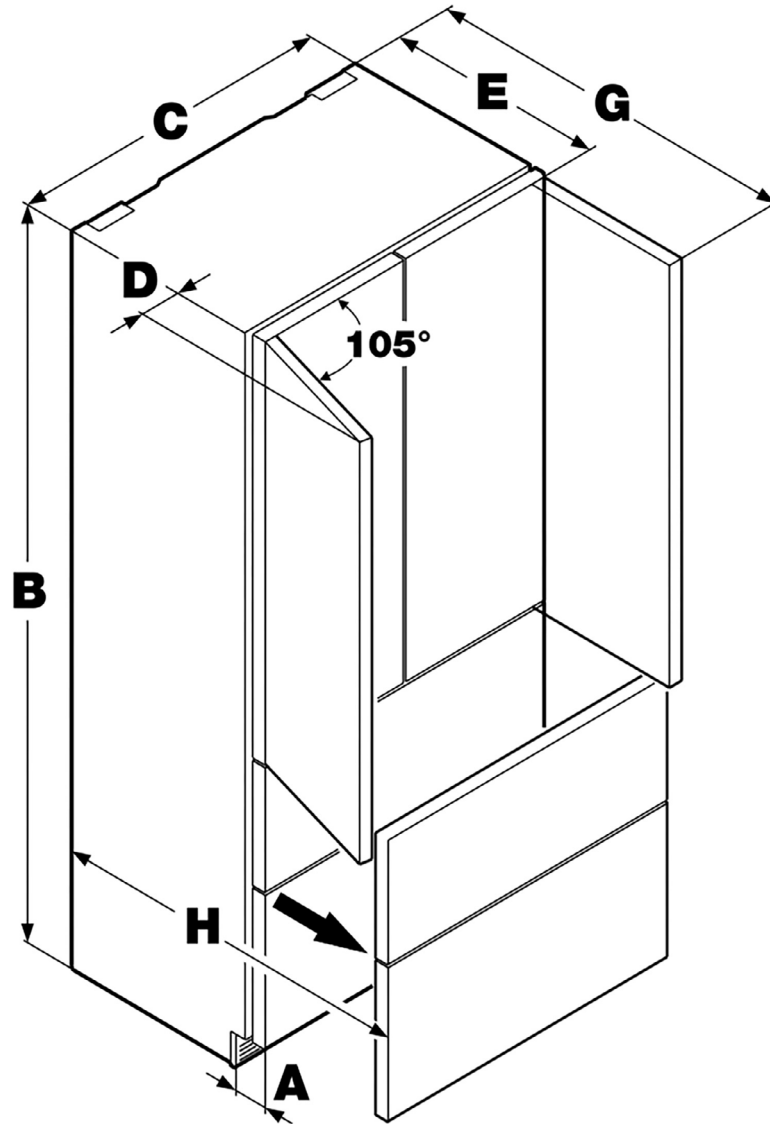

A = 3" (76 mm)
B = 79-13/16" (2027 mm)
C = 35-13/16" (910 mm)
D = 3" (76 mm)
E = 24" (610 mm)
G = 42-7/16" (1078 mm)
H = 37-1/8" (943 mm)

36" Bottom Mount French Door Refrigerator KFNF 9955 iDE



Niche, Water Line, and Electrical Dimensions

Cabinet Height C	Inset cabinet Depth B	Frameless/faceframe cabinet Depth B
80"	24" + panel thickness	24"

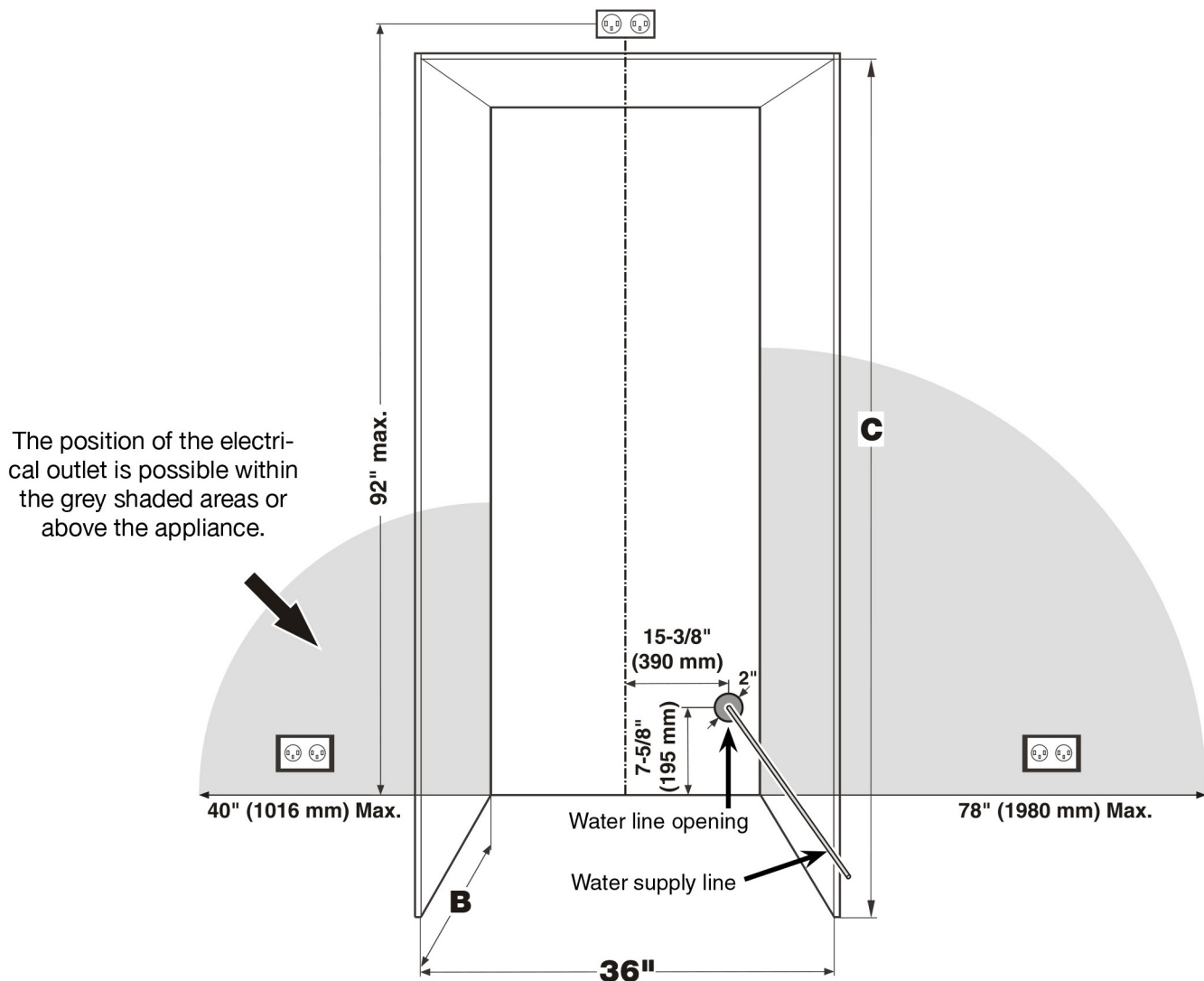

Important Notes:

- Do not install shut-off valve behind the appliance.
- For 24" cabinets, the water line opening must be in the location shown above.
- With Cabinets deeper than 24", there are no requirements for location of water line.
- The free length of the water supply line must be at least 31 1/2" (800 mm) when the tube comes out of the prescribed opening

36" Bottom Mount French Door Refrigerator KFNF 9955 iDE



Panel Details For Inset Installation

Appliance and panels sit fully within the opening and are flush with what could be its own box, between two pantry cabinets or decorative columns, etc. This is the most common installation scenario.

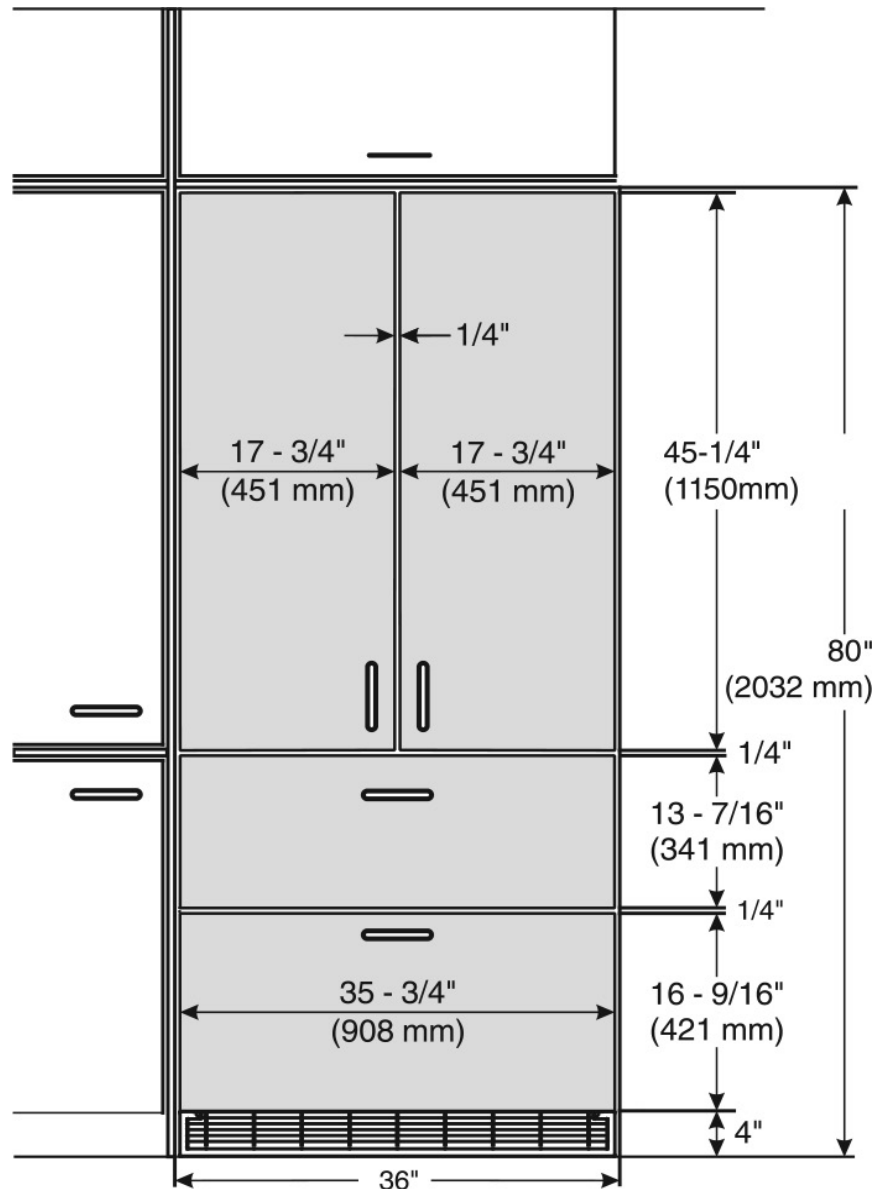

Important Notes:

- Maximum panel thickness is $\frac{3}{4}$ " (19 mm)
- Minimum panel thickness is $\frac{5}{8}$ " (16 mm)
- Gap between door panels is $\frac{1}{4}$ " (6 mm)

36" Bottom Mount French Door Refrigerator KFNF 9955 iDE



Panel Details For Frameless Installation

With this installation style, these wider appliance panels partially overlay the shared side gables of adjacent cabinetry so as to mimic the look of a frameless style cabinet.

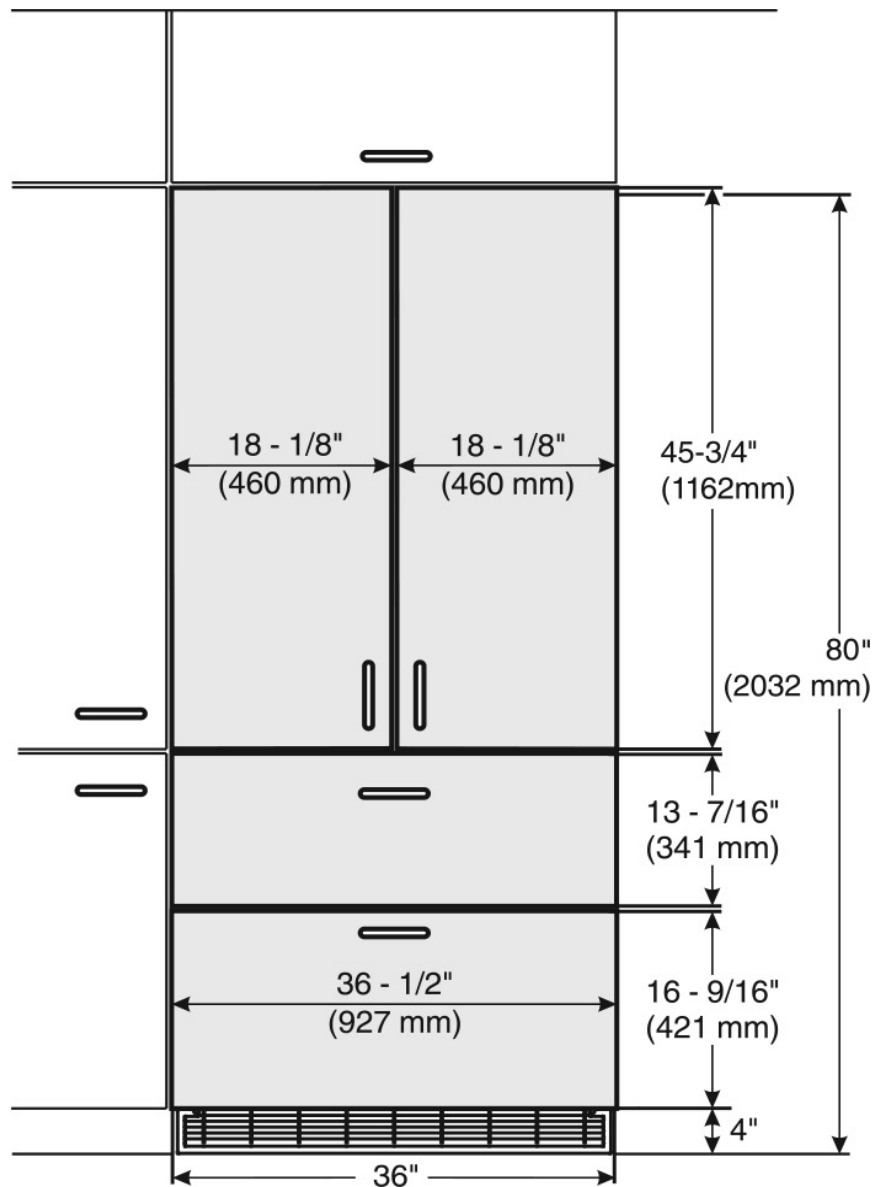

Important Notes:

- Maximum panel thickness is $\frac{3}{4}$ " (19 mm)
- Minimum panel thickness is $\frac{5}{8}$ " (16 mm)
- Gap between door panels is $\frac{1}{4}$ " (6 mm)
- Do not use cabinet doors that are wider than specified. Doing so may result in collision and damage to cabinet doors.

36" Bottom Mount French Door Refrigerator KFNF 9955 iDE



Door Swing Details

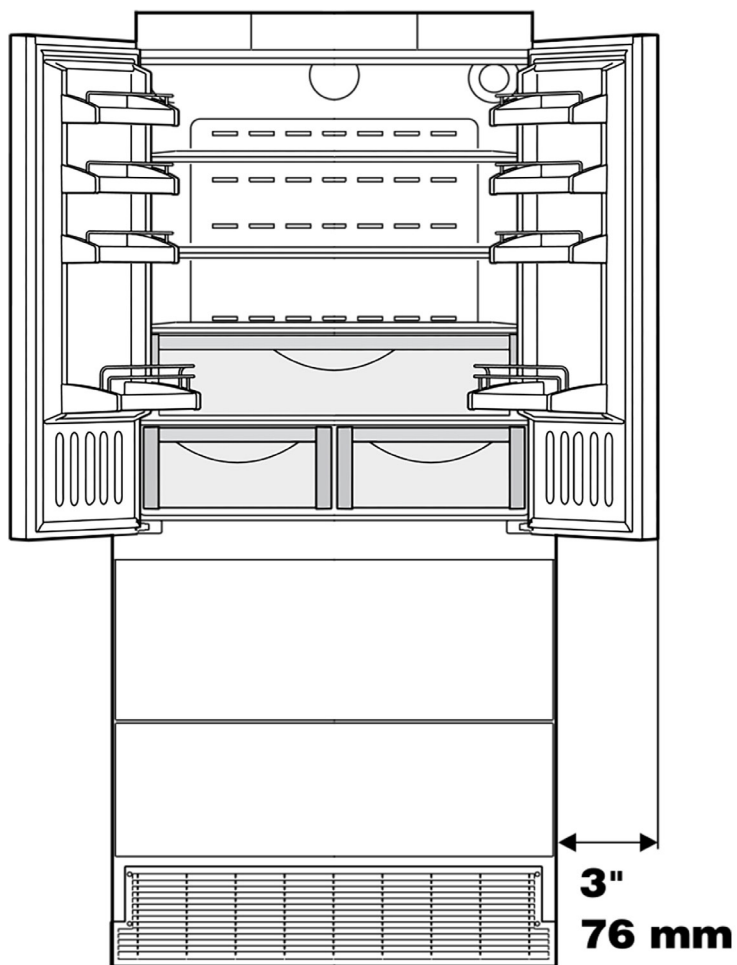

Important Notes:

- Please allow for door swing clearance at locations next to a wall
- The illustrated measurement is without mounted front panels. Be sure to add your panel thickness and handle depth to the measurement in order to avoid interferences.