

30" COMBINATION MICROWAVE/WALL OVENS

JMW3430D, JMW2430D – 30" x 43<sup>3</sup>/<sub>4</sub>" x 25<sup>5</sup>/<sub>16</sub>"

PRODUCT DIMENSIONS

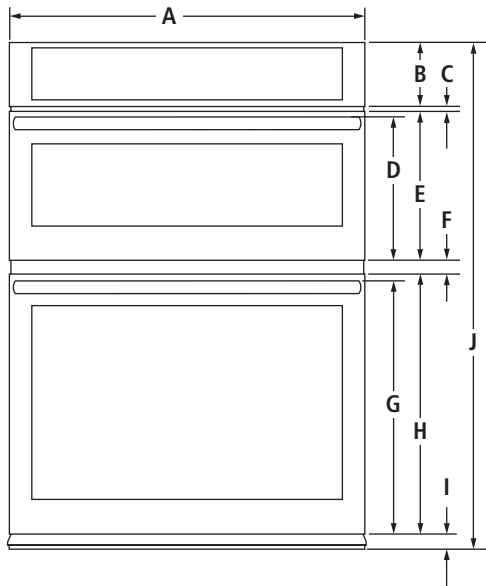

FRONT VIEW

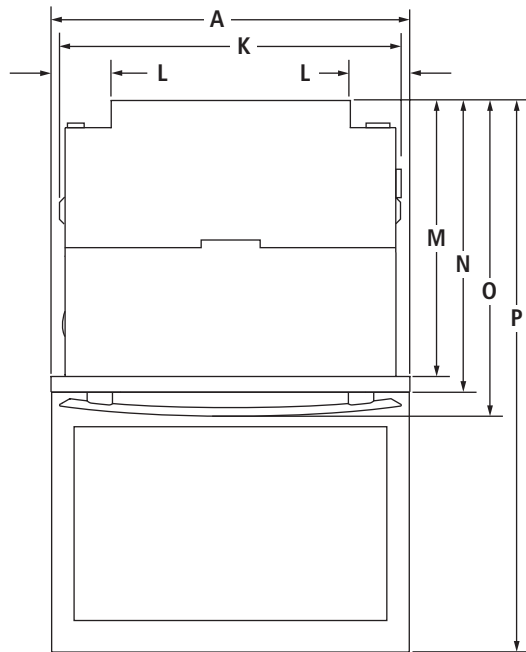

TOP VIEW

MODEL #		JMW3430D	
		JMW2430D	
		in	cm
A	Overall width		
	Pro-Style® Stainless or Euro-Style Stainless	30	76.2
	Floating Glass	29 <sup>15</sup> / <sub>16</sub>	76.1
B	Height of control panel	5 <sup>1</sup> / <sub>2</sub>	14
C	Space between control panel and door	<sup>1</sup> / <sub>2</sub>	1.2
D	Height to top of microwave oven handle		
	Pro-Style® Stainless	12 <sup>3</sup> / <sub>16</sub>	31.0
	Euro-Style (color-coordinating)	12 <sup>3</sup> / <sub>16</sub>	31.0
E	Height of microwave oven door	12 <sup>11</sup> / <sub>16</sub>	32.3
F	Space between doors	<sup>1</sup> / <sub>8</sub>	2.9
G	Height to top of oven handle		
	Pro-Style® Stainless	21 <sup>5</sup> / <sub>8</sub>	55.0
	Euro-Style (color-coordinating)	21 <sup>7</sup> / <sub>16</sub>	54.4
H	Height of oven door	22 <sup>1</sup> / <sub>8</sub>	56.2
I	Height of trim	1 <sup>11</sup> / <sub>16</sub>	4.3
J	Overall height	43 <sup>3</sup> / <sub>4</sub>	111.1
K	Width of recessed oven	28 <sup>7</sup> / <sub>16</sub>	72.2
L	Width of conduit channel	4 <sup>15</sup> / <sub>16</sub>	12.5
M	Depth of recessed oven	23 <sup>1</sup> / <sub>4</sub>	59.0
N	Depth with doors	24 <sup>3</sup> / <sub>8</sub>	61.9
O	Depth with handles		
	Pro-Style® Stainless	26 <sup>3</sup> / <sub>8</sub>	67.0
	Euro-Style (color-coordinating)	25 <sup>5</sup> / <sub>16</sub>	64.3
P	Depth with door fully open	45 <sup>3</sup> / <sub>8</sub>	115.3

**IMPORTANT:** Dimensional specifications are provided for planning purposes only. Do not make any cutouts based on this information. Refer to the Installation Guide before selecting cabinetry, verifying electrical/gas connections, making cutouts or beginning installation. All Jenn-Air® appliances are appropriately UL, CUL or CSA approved.

30" COMBINATION MICROWAVE/WALL OVENS

JMW3430D, JMW2430D – 30" x 43¾" x 25⅝"

DIMENSIONS AS INSTALLED

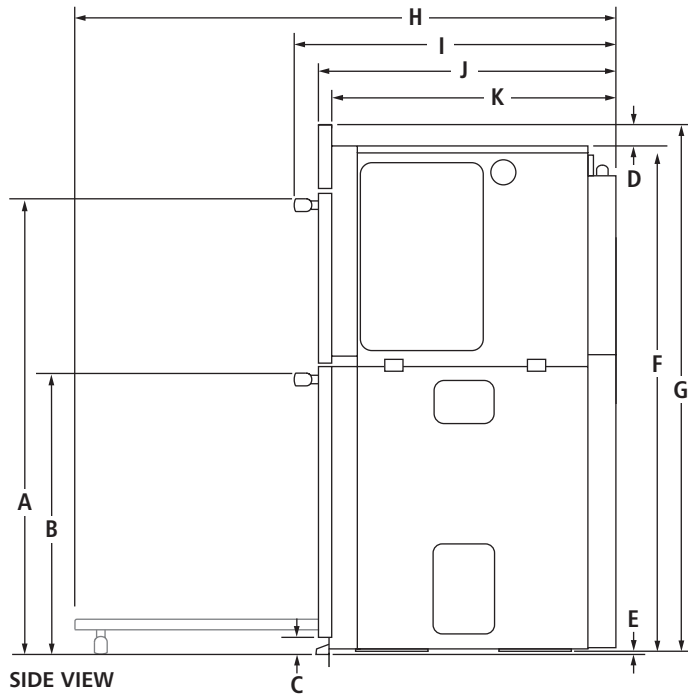

MODEL #	JMW3430D JMW2430D		
	in	cm	
A	Height to top of upper handle Pro-Style® Stainless	36½	92.7
	Euro-Style (color-coordinating)	36½	92.7
B	Height to top of lower handle Pro-Style® Stainless	23⅜	59.3
	Euro-Style (color-coordinating)	23⅜	58.7
C	Height of trim extending below cutout	1⅞	4.3
D	Height from top of recessed oven to top of control panel JMW3430D	2½	6.3
	JMW2430D	2⅝	7.4
E	Height from bottom of recessed oven foot to bottom of oven vent	⅜	0.5
F	Height of recessed oven	41	104.2
G	Height to top of control panel	43¾	111.1
H	Depth with door fully open	45⅝	115.3
I	Depth with handles Pro-Style® Stainless	26⅜	67.0
	Euro-Style (color-coordinating)	25⅝	64.3
J	Depth with doors	24⅜	61.9
K	Depth of recessed oven	23¼	59.0

**IMPORTANT:** Dimensional specifications are provided for planning purposes only. Do not make any cutouts based on this information. Refer to the Installation Guide before selecting cabinetry, verifying electrical/gas connections, making cutouts or beginning installation. All Jenn-Air® appliances are appropriately UL, CUL or CSA approved.

30" COMBINATION MICROWAVE/WALL OVENS

JMW3430D, JMW2430D – 30" x 43<sup>3</sup>/<sub>4</sub>" x 25<sup>5</sup>/<sub>16</sub>"

OPENING/CLEARANCE DIMENSIONS

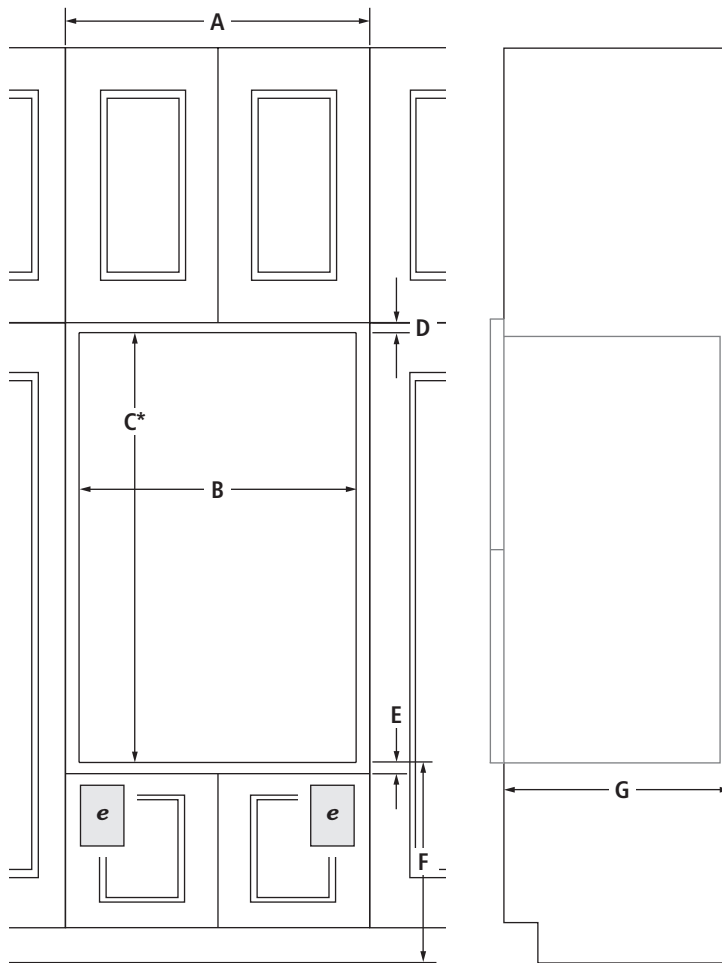

FRONT VIEW

SIDE VIEW

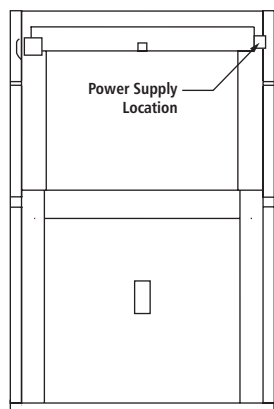

BACK VIEW

MODEL #		JMW3430D	
		JMW2430D	
		in	cm
<b>A</b>	Width of cabinet (min.)	30	76.2
<b>B</b>	Width of cutout	28½	72.4
<b>C*</b>	Height of cutout (recommended)	41 <sup>5</sup> / <sub>16</sub>	104.9
<b>D</b>	Top of cutout to bottom of upper cabinet door (min.)	2¼	5.7
<b>E</b>	Bottom of cutout to top of lower cabinet door (min.)	1½	3.8
<b>F</b>	Bottom of cutout to floor	4-19¼	10.2-48.9
<b>G</b>	Depth of cutout (min.)	24	61.0
<b>e</b>	Recommended junction box location		

\* Will fit cutout height from 41" (104.1 cm) to 41½" (105.4 cm).

**ELECTRICAL REQUIREMENTS**

240 volt, 40-amp fused, grounded circuit is required. A dedicated circuit is required.

The length of conduit provided is for serviceability. Do not cut the conduit. The junction box should be located 3" (7.6 cm) maximum below the support surface. Drill a 1" (2.5 cm) minimum diameter hole in the right rear or left rear corner of the support surface for access to the junction box.

**IMPORTANT:** Dimensional specifications are provided for planning purposes only. Do not make any cutouts based on this information. Refer to the Installation Guide before selecting cabinetry, verifying electrical/gas connections, making cutouts or beginning installation. All Jenn-Air® appliances are appropriately UL, CUL or CSA approved.

30" COMBINATION MICROWAVE/WALL OVENS – FLUSH INSTALLATION

JMW3430D, JMW2430D – 30" x 43¾" x 24⅜" (depth without handles)

OPENING/CLEARANCE DIMENSIONS

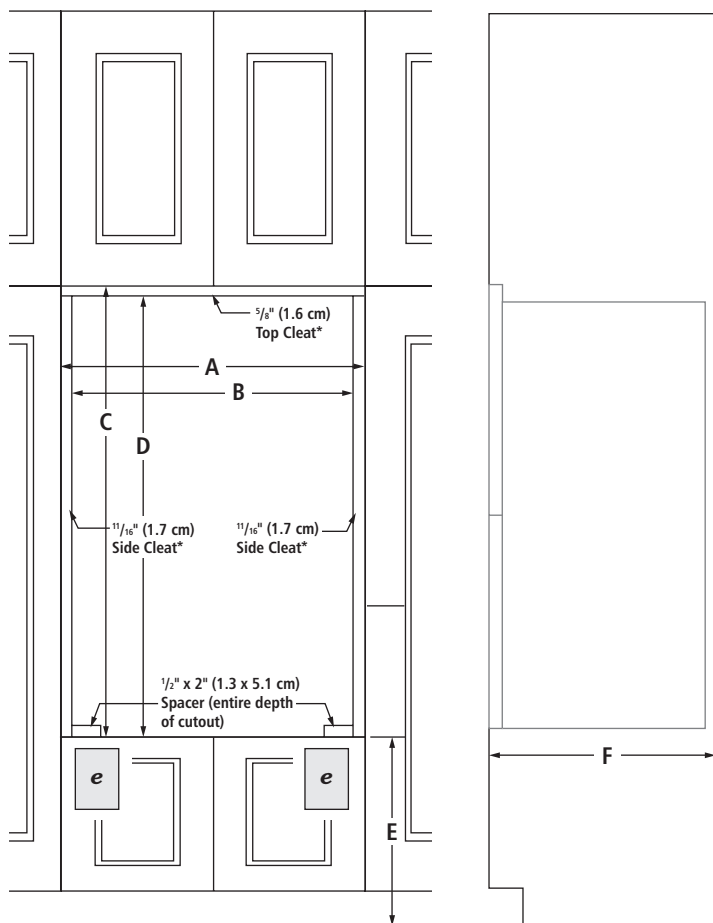

FRONT VIEW

SIDE VIEW

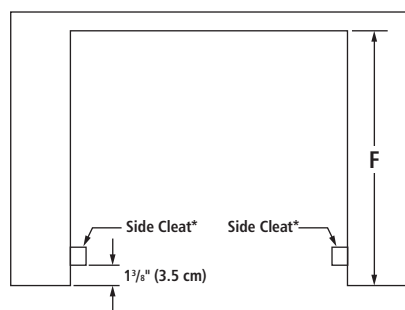

TOP VIEW

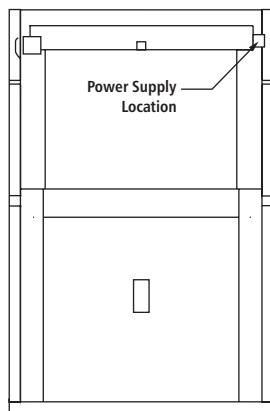

BACK VIEW

\* Cleats and spacers must be recessed 1⅜" (3.5 cm) from the front of the cabinet.

MODEL #	JMW3430D JMW2430D	
	in	cm
A	Width of flush inset cutout (min.)	30¼ 76.8
B	Width of opening (min.)	28⅞ 73.3
C	Height of flush inset cutout (min.)	44⅝ 112.5
D	Height of opening (min.)	43⅞ 110.9
E	Bottom of cutout to floor	4⅞- 11.7- 19¼ 48.9
F	Depth of cutout (min.)	25 63.5
e	Recommended junction box location	

ELECTRICAL REQUIREMENTS

240 volt, 40-amp fused, grounded circuit is required. A dedicated circuit is required.

The length of conduit provided is for serviceability. Do not cut the conduit. The junction box should be located 3" (7.6 cm) maximum below the support surface. Drill a 1" (2.5 cm) minimum diameter hole in the right rear or left rear corner of the support surface for access to the junction box.

FLUSH INSTALLATION REQUIREMENTS

A 25" (63.5 cm) minimum cutout depth is required.

These dimensions will result in a ¼" (0.6 cm) reveal on the top, a ¼" (0.6 cm) reveal on the sides and a ⅛" (0.3 cm) reveal on the bottom of the wall oven.

The front face of the cleats and spacers will be visible and should be treated as a finished surface.

**IMPORTANT:** Dimensional specifications are provided for planning purposes only. Do not make any cutouts based on this information. Refer to the Installation Guide before selecting cabinetry, verifying electrical/gas connections, making cutouts or beginning installation. All Jenn-Air® appliances are appropriately UL, CUL or CSA approved.

