

## 30" DOUBLE WALL OVENS

JJW3830D, JJW2830D, JJW2730D – 30" x 52<sup>3</sup>/<sub>8</sub>" x 25<sup>5</sup>/<sub>16</sub>"

### PRODUCT DIMENSIONS

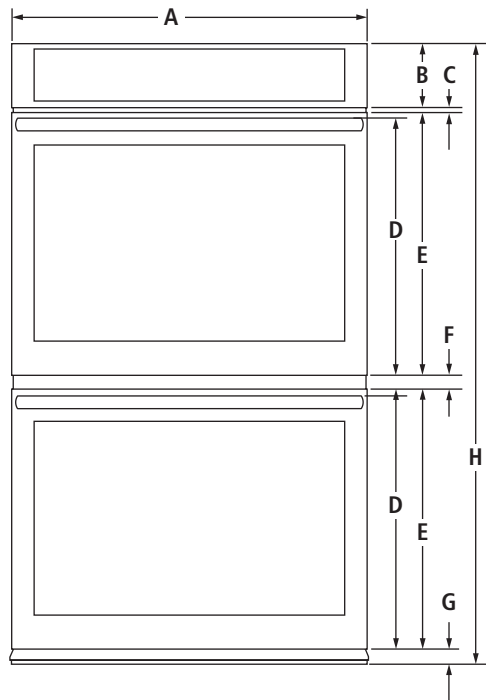

FRONT VIEW

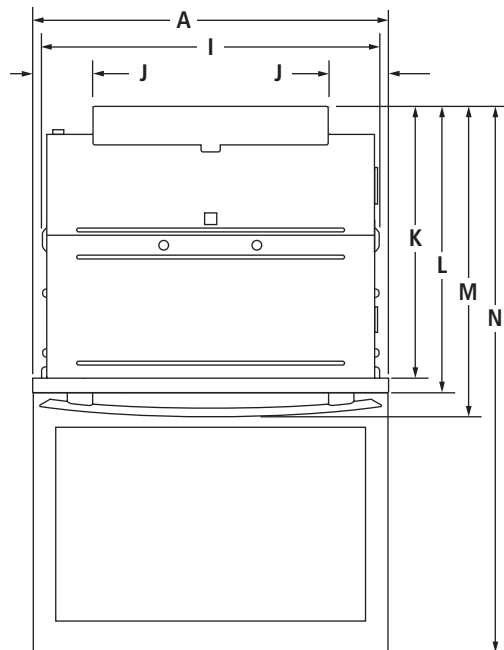

TOP VIEW

MODEL #		JJW3830D JJW2830D		JJW2730D	
		in	cm	in	cm
A	Overall width Pro-Style® Stainless or Euro-Style Stainless	30	76.2	30	76.2
	Floating Glass	29 <sup>15</sup> / <sub>16</sub>	76.1	—	—
B	Height of control panel	5 <sup>1</sup> / <sub>2</sub>	14.0	5 <sup>1</sup> / <sub>2</sub>	14.0
C	Space between control panel and door	<sup>7</sup> / <sub>16</sub>	1.1	<sup>7</sup> / <sub>16</sub>	1.1
D	Height to top of handle Pro-Style® Stainless	21 <sup>11</sup> / <sub>16</sub>	55.0	—	—
	Euro-Style (color-coordinating)	21 <sup>7</sup> / <sub>16</sub>	54.4	21 <sup>7</sup> / <sub>16</sub>	54.4
E	Height of door	22 <sup>1</sup> / <sub>8</sub>	56.2	22 <sup>1</sup> / <sub>8</sub>	56.2
F	Space between doors	<sup>1</sup> / <sub>16</sub>	1.7	<sup>1</sup> / <sub>16</sub>	1.7
G	Height of trim	1 <sup>11</sup> / <sub>16</sub>	4.3	1 <sup>11</sup> / <sub>16</sub>	4.3
H	Overall height	52 <sup>3</sup> / <sub>8</sub>	133.0	52 <sup>3</sup> / <sub>8</sub>	133.0
I	Width of recessed oven	28 <sup>7</sup> / <sub>16</sub>	72.2	28 <sup>7</sup> / <sub>16</sub>	72.2
J	Width of conduit channel	2 <sup>1</sup> / <sub>2</sub>	6.3	2 <sup>1</sup> / <sub>2</sub>	6.3
K	Depth of recessed oven	23 <sup>1</sup> / <sub>8</sub>	58.7	23 <sup>1</sup> / <sub>8</sub>	58.7
L	Depth with doors	24 <sup>5</sup> / <sub>16</sub>	61.8	24 <sup>5</sup> / <sub>16</sub>	61.8
M	Depth with handles Pro-Style® Stainless	26 <sup>5</sup> / <sub>16</sub>	66.9	—	—
	Euro-Style (color-coordinating)	25 <sup>5</sup> / <sub>16</sub>	64.3	25 <sup>5</sup> / <sub>16</sub>	64.3
N	Depth with door fully open	45 <sup>3</sup> / <sub>8</sub>	115.3	45 <sup>3</sup> / <sub>8</sub>	115.3

**IMPORTANT:** Dimensional specifications are provided for planning purposes only.

**Do not make any cutouts based on this information.** Refer to the Installation Guide *before* selecting cabinetry, verifying electrical/gas connections, making cutouts or beginning installation. All Jenn-Air® appliances are appropriately UL, CUL or CSA approved.

30" DOUBLE WALL OVENS

JJW3830D, JJW2830D, JJW2730D – 30" x 52<sup>3</sup>/<sub>8</sub>" x 25<sup>5</sup>/<sub>16</sub>"

DIMENSIONS AS INSTALLED

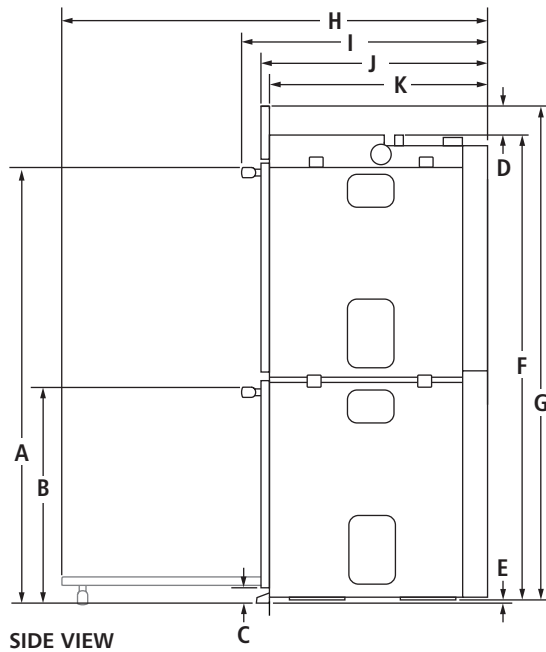

MODEL #		JJW3830D JJW2830D		JJW2730D	
		in	cm	in	cm
A	Height to top of upper handle Pro-Style® Stainless	46 <sup>1</sup> / <sub>8</sub>	117.1	—	—
	Euro-Style (color-coordinating)	46 <sup>1</sup> / <sub>8</sub>	117.1	46 <sup>1</sup> / <sub>8</sub>	117.1
B	Height to top of lower handle Pro-Style® Stainless	23 <sup>5</sup> / <sub>16</sub>	59.2	—	—
	Euro-Style (color-coordinating)	23 <sup>5</sup> / <sub>16</sub>	59.2	23 <sup>5</sup> / <sub>16</sub>	59.2
C	Height of trim extending below cutout	1/4	0.6	1/4	0.6
D	Height from top of recessed oven to top of control panel JJW3830D	2 <sup>1</sup> / <sub>2</sub>	6.3	—	—
	JJW2830D, JJW2730D	2 <sup>15</sup> / <sub>16</sub>	7.4	2 <sup>15</sup> / <sub>16</sub>	7.4
E	Height from bottom of recessed oven foot to bottom of oven vent	3/16	0.5	3/16	0.5
F	Height of recessed oven	48 <sup>13</sup> / <sub>16</sub>	124.0	48 <sup>13</sup> / <sub>16</sub>	124.0
G	Height to top of control panel	52 <sup>3</sup> / <sub>8</sub>	133.0	52 <sup>3</sup> / <sub>8</sub>	133.0
H	Depth with door fully open	45 <sup>3</sup> / <sub>8</sub>	115.3	45 <sup>3</sup> / <sub>8</sub>	115.3
I	Depth with handles Pro-Style® Stainless	26 <sup>5</sup> / <sub>16</sub>	66.9	—	—
	Euro-Style (color-coordinating)	25 <sup>5</sup> / <sub>16</sub>	64.3	25 <sup>5</sup> / <sub>16</sub>	64.3
J	Depth with doors	24 <sup>5</sup> / <sub>16</sub>	61.8	24 <sup>5</sup> / <sub>16</sub>	61.8
K	Depth of recessed oven	23 <sup>1</sup> / <sub>8</sub>	58.7	23 <sup>1</sup> / <sub>8</sub>	58.7

**IMPORTANT:** Dimensional specifications are provided for planning purposes only.  
**Do not make any cutouts based on this information.** Refer to the Installation Guide *before* selecting cabinetry, verifying electrical/gas connections, making cutouts or beginning installation.  
 All Jenn-Air® appliances are appropriately UL, CUL or CSA approved.

30" DOUBLE WALL OVENS

JJW3830D, JJW2830D, JJW2730D – 30" x 52<sup>3</sup>/<sub>8</sub>" x 25<sup>5</sup>/<sub>16</sub>"

OPENING/CLEARANCE DIMENSIONS

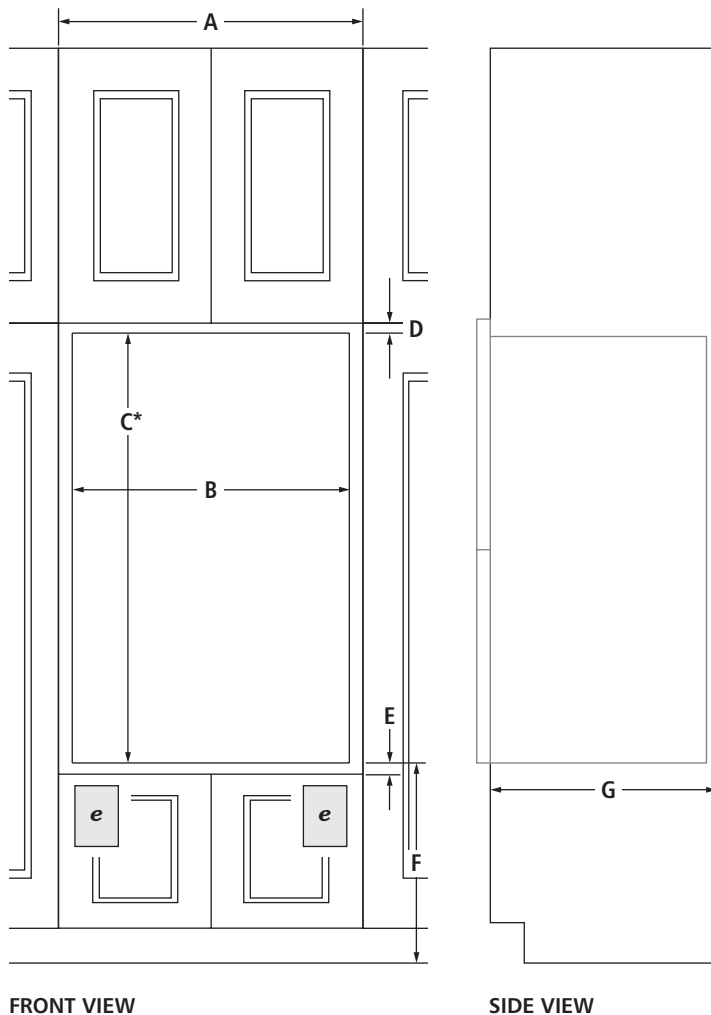

FRONT VIEW

SIDE VIEW

MODEL #		JJW3830D JJW2830D JJW2730D	
		in	cm
A	Width of cabinet (min.)	30	76.2
B	Width of cutout	28 <sup>1</sup> / <sub>2</sub>	72.4
C*	Height of cutout (recommended)	50 <sup>1</sup> / <sub>4</sub>	127.6
D	Top of cutout to bottom of upper cabinet door (min.)	2 <sup>3</sup> / <sub>16</sub>	5.5
E	Bottom of cutout to top of lower cabinet door (min.)	1 <sup>1</sup> / <sub>2</sub>	3.8
F	Bottom of cutout to floor	4-14 <sup>3</sup> / <sub>4</sub>	10.2-37.5
G	Depth of cutout (min.)	24	61.0
e	Recommended junction box location		

\*Will fit cutout height from 49<sup>1</sup>/<sub>2</sub>" (125.7 cm) to 52<sup>3</sup>/<sub>8</sub>" (132.6 cm).

**ELECTRICAL REQUIREMENTS**

240 volt, 40-amp fused, grounded circuit is required. A dedicated circuit is required.

The length of conduit provided is for serviceability. Do not cut the conduit. The junction box should be located 3" (7.6 cm) maximum below the support surface. Drill a 1" (2.5 cm) minimum diameter hole in the right rear or left rear corner of the support surface for access to the junction box.

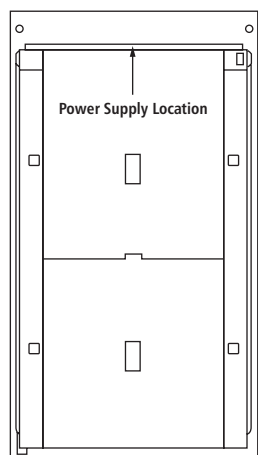

BACK VIEW

**IMPORTANT:** Dimensional specifications are provided for planning purposes only. Do not make any cutouts based on this information. Refer to the Installation Guide before selecting cabinetry, verifying electrical/gas connections, making cutouts or beginning installation. All Jenn-Air® appliances are appropriately UL, CUL or CSA approved.

30" DOUBLE WALL OVENS – FLUSH INSTALLATION

JJW3830D, JJW2830D, JJW2730D – 30" x 52<sup>3</sup>/<sub>8</sub>" x 24<sup>5</sup>/<sub>16</sub>" (depth without handles)

OPENING/CLEARANCE DIMENSIONS

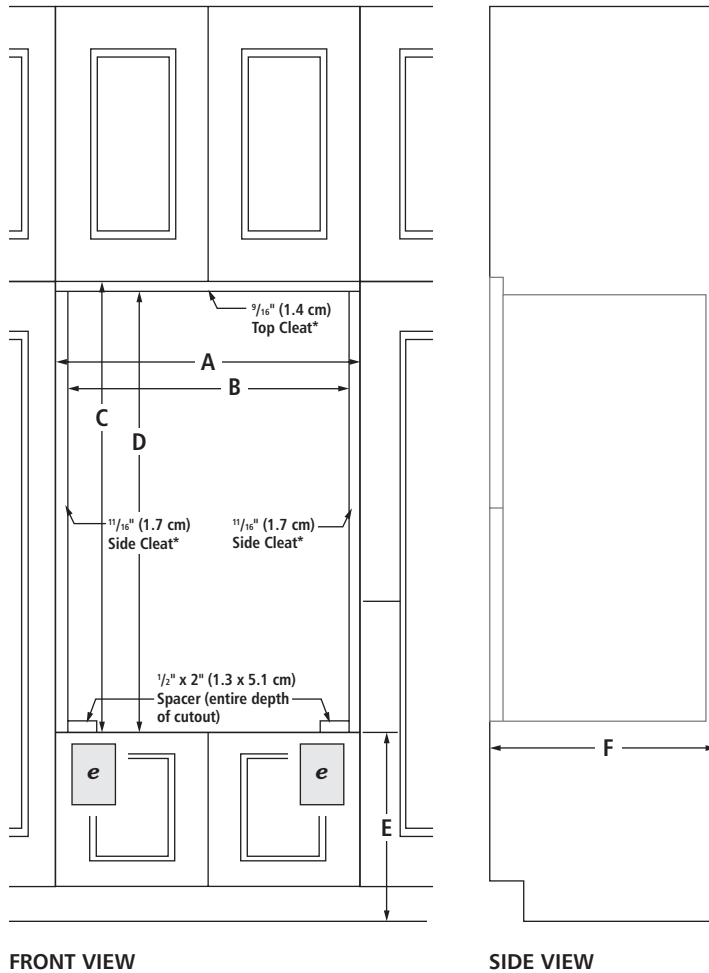

FRONT VIEW

SIDE VIEW

MODEL #		JJW3830D JJW2830D JJW2730D	
		in	cm
A	Width of flush inset cutout (min.)	30 <sup>1</sup> / <sub>4</sub>	76.8
B	Width of opening (min.)	28 <sup>7</sup> / <sub>8</sub>	73.3
C	Height of flush inset cutout (min.)	53 <sup>3</sup> / <sub>16</sub>	135.1
D	Height of opening (min.)	52 <sup>5</sup> / <sub>8</sub>	133.6
E	Bottom of cutout to floor	4 <sup>7</sup> / <sub>8</sub> - 14 <sup>3</sup> / <sub>4</sub>	11.7- 37.5
F	Depth of cutout (min.)	25	63.5
e	Recommended junction box location		

ELECTRICAL REQUIREMENTS

240 volt, 40-amp fused, grounded circuit is required. A dedicated circuit is required.

The length of conduit provided is for serviceability. Do not cut the conduit. The junction box should be located 3" (7.6 cm) maximum below the support surface. Drill a 1" (2.5 cm) minimum diameter hole in the right rear or left rear corner of the support surface for access to the junction box.

FLUSH INSTALLATION REQUIREMENTS

A 25" (63.5 cm) minimum cutout depth is required.

These dimensions will result in a 1/4" (0.6 cm) reveal on the top, a 1/4" (0.6 cm) reveal on the sides and a 1/8" (0.3 cm) reveal on the bottom of the wall oven.

The front face of the cleats and spacers will be visible and should be treated as a finished surface.

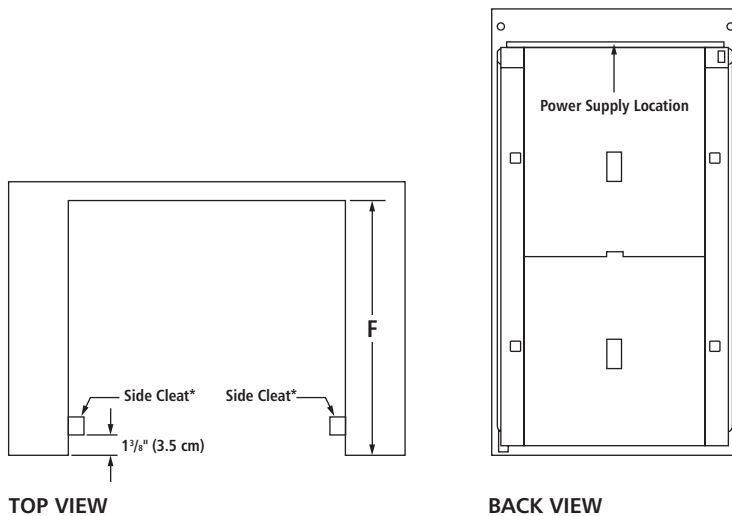

TOP VIEW

BACK VIEW

\* Cleats and spacers must be recessed 1<sup>3</sup>/<sub>8</sub> (3.5 cm) from the front of the cabinet.

**IMPORTANT:** Dimensional specifications are provided for planning purposes only. Do not make any cutouts based on this information. Refer to the Installation Guide before selecting cabinetry, verifying electrical/gas connections, making cutouts or beginning installation. All Jenn-Air® appliances are appropriately UL, CUL or CSA approved.