

30" DUAL-FUEL AND GAS RANGES
JDS1450E, JGS1450F – 29⁷/₈" x 36" x 28⁵/₁₆"

PRODUCT DIMENSIONS

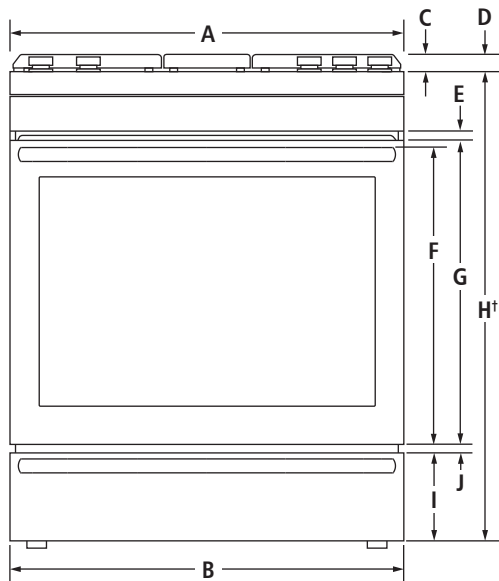

FRONT VIEW

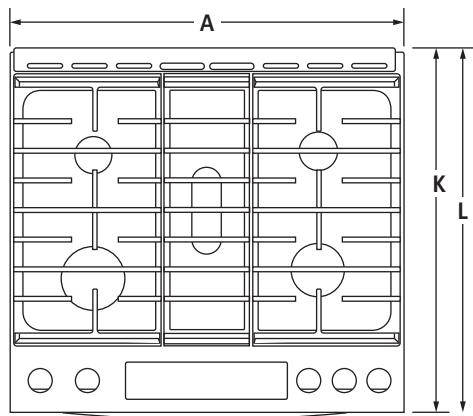

TOP VIEW

| MODEL # | | JDS1450F JGS1450F | |
|----------|---|----------------------------------|------|
| | | in | cm |
| A | Overall width | 29 ⁷ / ₈ | 75.9 |
| B | Width of door/drawer | 29 ⁷ / ₈ | 75.9 |
| C | Height from cooktop to top of vent | 1 ³ / ₁₆ | 3.0 |
| D | Height with grates | 37 ⁷ / ₈ | 96.2 |
| | Height with vent* | 37 ³ / ₈ | 95.0 |
| E | Space between door and control panel | 1 ³ / ₁₆ | 2.1 |
| F | Height to top of handle Pro-Style® Stainless | 22 ⁷ / ₈ | 58.1 |
| | Euro-Style (color-coordinating) | 22 ⁷ / ₈ | 58.1 |
| G | Height of door | 23 ¹ / ₄ | 59.0 |
| H | Height to top of cooktop edge | 36 | 91.4 |
| I | Height of warming drawer | 6 ⁵ / ₁₆ | 16.0 |
| J | Space between door and warming drawer | 1 ³ / ₁₆ | 2.0 |
| K | Depth from front of console to back of range (max.) | 27 ¹³ / ₁₆ | 70.7 |
| L | Depth from handle to back of range (max.) Pro-Style® Stainless | 28 ¹⁵ / ₁₆ | 73.5 |
| | Euro-Style (color-coordinating) | 28 ⁵ / ₁₆ | 71.9 |

*Model JGS1450F.

[†]With leveling legs screwed all the way in. Range can be raised approximately 1" (2.5 cm) by adjusting the leveling legs.

IMPORTANT: Dimensional specifications are provided for planning purposes only. Do not make any cutouts based on this information. Refer to the Installation or Use & Care Guide BEFORE selecting cabinetry, verifying electrical/gas connections, making cutouts or beginning installation. All Jenn-Air® appliances are appropriately UL, CUL or CSA approved.

30" DUAL-FUEL AND GAS RANGES

JDS1450E, JGS1450F – 29⁷/₈" x 36" x 28⁵/₁₆"

DIMENSIONS AS INSTALLED

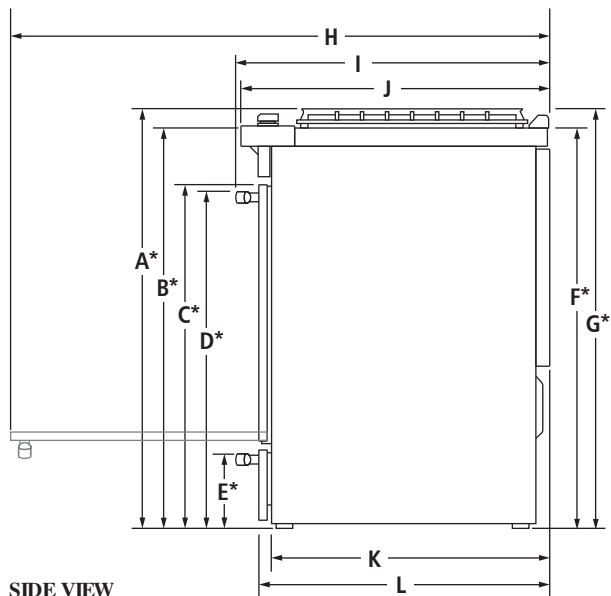

SIDE VIEW

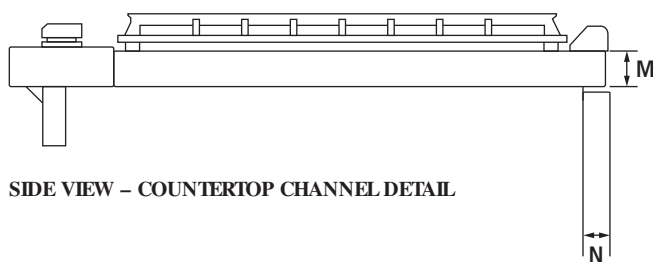

SIDE VIEW – COUNTERTOP CHANNEL DETAIL

| MODEL # | JDS1450F JGS1450F | |
|---------|---|---------------------------------------|
| | in | cm |
| A* | Height to top of grates (min.) | 37 ⁷ / ₈ 96.2 |
| B* | Height to top of cooking surface (min.) | 35 ¹ / ₂ 90.2 |
| C* | Height to top of door (min.) | 30 ¹¹ / ₁₆ 78.0 |
| D* | Height to top of handle (min.) | |
| | Pro-Style® Stainless | 30 ¹ / ₂ 77.5 |
| | Euro-Style (color-coordinating) | 30 ¹ / ₂ 77.5 |
| E* | Height to top of warming drawer (min.) | 6 ⁷ / ₈ 17.5 |
| F* | Height to top of countertop (min.) | 35 ¹³ / ₁₆ 91.0 |
| G* | Height to top of vent (min.)** | 37 ³ / ₈ 95.0 |
| H | Depth with door fully open | 50 ⁹ / ₁₆ 128.5 |
| I | Depth with handle | |
| | Pro-Style® Stainless | 28 ¹⁵ / ₁₆ 73.5 |
| | Euro-Style (color-coordinating) | 28 ⁵ / ₁₆ 71.9 |
| J | Depth from front of console to back of range (max.) | 27 ¹³ / ₁₆ 70.7 |
| K | Depth without door | 25 63.5 |
| L | Depth with door | 26 ⁵ / ₁₆ 66.8 |
| M | Height of countertop channel | 1 ¹³ / ₁₆ 4.6 |
| N | Depth to countertop channel | 1 ³ / ₁₆ 3.0 |

*With leveling legs screwed all the way in. Range can be raised approximately 1" (2.5 cm) by adjusting the leveling legs.

**Model JGS1450F.

IMPORTANT: Dimensional specifications are provided for planning purposes only. Do not make any cutouts based on this information. Refer to the Installation or Use & Care Guide BEFORE selecting cabinetry, verifying electrical/gas connections, making cutouts or beginning installation. All Jenn-Air® appliances are appropriately UL, CUL or CSA approved.

30" DUAL-FUEL AND GAS RANGES

JDS1450E, JGS1450F – 29⁷/₈" x 36" x 28⁵/₁₆"

OPENING/CLEARANCE DIMENSIONS

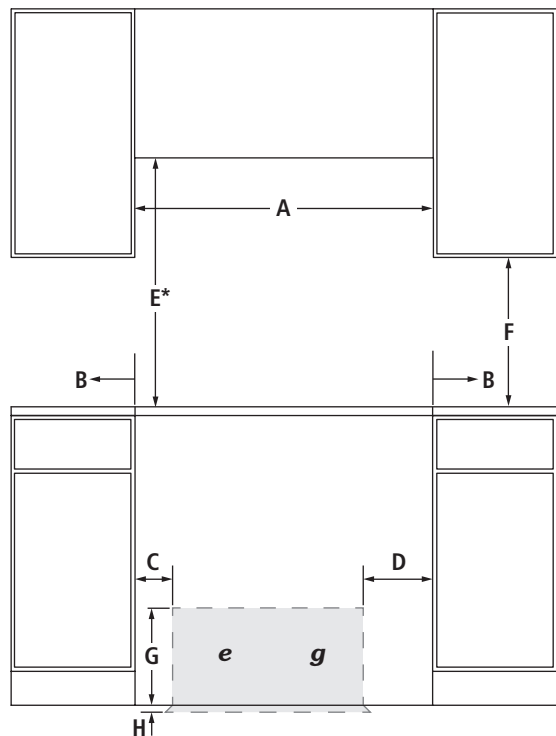

FRONT VIEW

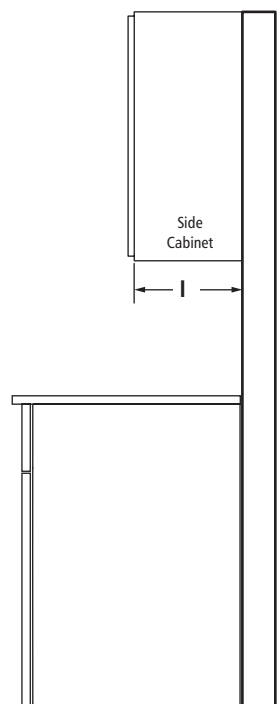

SIDE VIEW

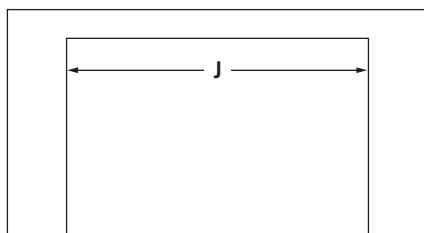

TOP VIEW – CUTOUT

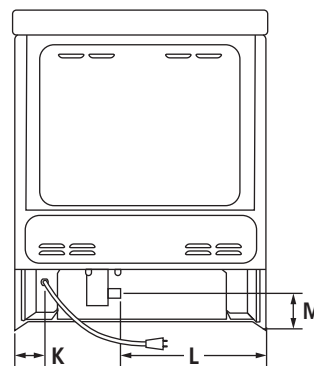

BACK VIEW

| MODEL # | JDS1450F JGS1450F | |
|---------|--|---------------------------------------|
| | in | cm |
| A | Width of combustable area above cooking surface (min.) | 30 76.2 |
| B | Width from cooktop to fixed wall or other combustable material (min.) | 3 7.6 |
| C | Width from electrical installation area to cabinet (min.) | 4 ¹³ / ₁₆ 12.2 |
| D | Width from gas installation area to cabinet (min.) | 12 30.5 |
| E* | Height to bottom of uncovered wood or metal cabinet above cooking surface (min.) | 30 76.2 |
| F | Height to bottom of uncovered wood or metal cabinet (min.) | 18 45.7 |
| G | Height of electrical installation area (max.) | 7 ¹ / ₁₆ 19.5 |
| H | Depth of electrical installation area (max.) | 3 ¹¹ / ₁₆ 9.4 |
| I | Depth of upper cabinet (recommended) | 13 33.0 |
| J | Width of cutout (min.) | 30 76.2 |
| K | Width to power cord | 2 ³ / ₄ 7.0 |
| L | Width to gas inlet | 17 ¹⁵ / ₁₆ 45.5 |
| M | Height to gas inlet | 4 ⁷ / ₁₆ 11.3 |
| e | Recommended junction box location | |
| g | Recommended gas access location | |

*Dimension can be reduced by 6" (15.2 cm) when bottom of wood or metal cabinet is covered by not less than 1/4" (0.6 cm) flame retardant millboard covered with not less than No. 28 MSG sheet metal, 0.015" (0.4 mm) stainless steel, 0.024" (0.6 mm) aluminum or 0.020" (0.5 mm) copper.

If installing a hood or microwave hood combination above the range, follow the hood or microwave hood combination instructions for dimensional clearances above the cooking surface.

ELECTRICAL REQUIREMENTS

JDS1450F: 240 volt, 60 Hz, AC only, 40-amp fused, grounded circuit is required. A dedicated circuit is recommended. Minimum length of power cord is 48" (121.9 cm).

JGS1450F: 120 volt, 60 Hz, AC only, 15-amp fused, grounded circuit is required. A dedicated circuit is recommended. Minimum length of power cord is 48" (121.9 cm).

IMPORTANT: Dimensional specifications are provided for planning purposes only. Do not make any cutouts based on this information. Refer to the Installation or Use & Care Guide BEFORE selecting cabinetry, verifying electrical/gas connections, making cutouts or beginning installation. All Jenn-Air® appliances are appropriately UL, CUL or CSA approved.

