

# PIK SERIES INSERT

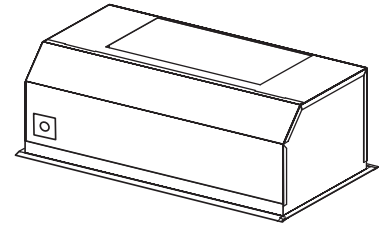

Especially designed to be installed in custom hood for use over residential commercial-style cooking surfaces.

### FEATURES

- Cabinet mount – custom application
- Widths: 33", 45"
- Halogen lighting (33" – 2 x 50 watt; 45" – 3 x 50 watt GU10) Lamps included
- Slide controls: Lighting, on-off, infinite speed
- Easily accessible, dishwasher-safe stainless steel baffle filters
- Heat Sentry™ turns blower ON to HIGH speed when excess heat is detected
- For indoor use only

### OPTIONS

- Custom hood liners (L33 or L45 Series):  
Widths - 36", 42", 48", 54" and 60"  
Adjustable depth - see liner spec. sheet for details  
Stainless Steel construction - protects custom hood base and wipes clean easily
- Ambient light panel (ALP Series) for L Series custom hood liners (Halogen lighting: 36" and 42" – 2 x 50 watt; 48", 54" and 60" – 3 x 50 watt GU10) Lamps included
- Backsplash (RMP Series):  
Widths - 36", 42", 48", 60"  
Stainless Steel construction - protects back wall and wipes clean easily
- WCPI Remote control: With Stainless Steel faceplate, to fit any décor.

### INSERT SPECIFICATIONS

120 VAC, 60 Hz  
Amps (without blower) 0.8 (PIK33), 1.3 (PIK45)

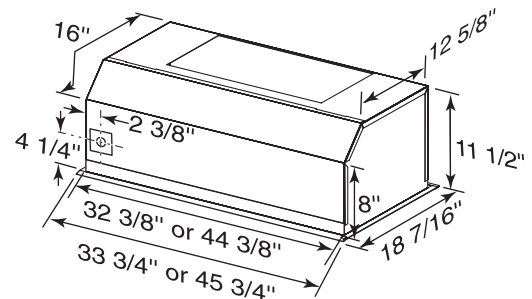

Mount insert so bottom of custom hood is 24" to 30" above cooking surface.

Custom Hood Liner  
L33 or L45 Series

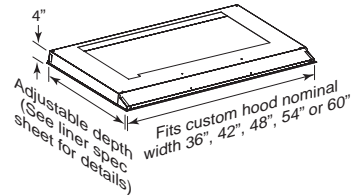

Ambient Light Panel  
ALP Series

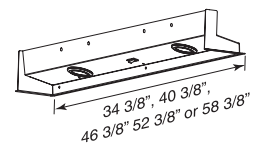

Backsplash  
RMP Series

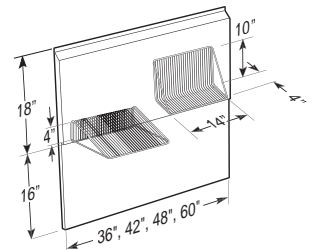

WCPI Remote Control

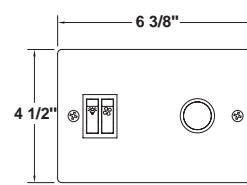

BEST Hartford, Wisconsin [www.BestRangeHoods.com](http://www.BestRangeHoods.com) 800-558-1711  
BEST Drummondville, QC Canada [www.BestRangeHoods.com](http://www.BestRangeHoods.com) 866-737-7770

REFERENCE	QTY.	REMARKS	Project
			Location
			Architect
			Engineer
			Contractor
			Submitted by
			Date

# PIK MOUNTING

## SIZE OF THE CUT-OUT

NOTE: If optional L series liner is used, refer to installation instructions for size and location of the cut-out.

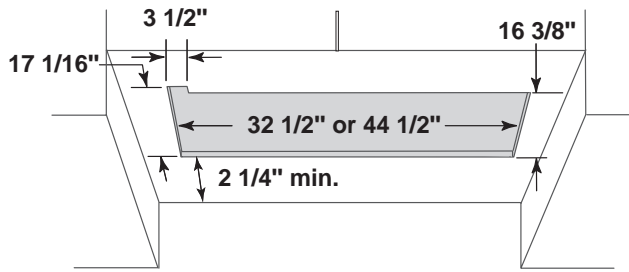

NOTE: The 3 1/2" notch must be cut only if the WCPI optional wall control will be installed.

## Suggested Custom Hood Internal Framework

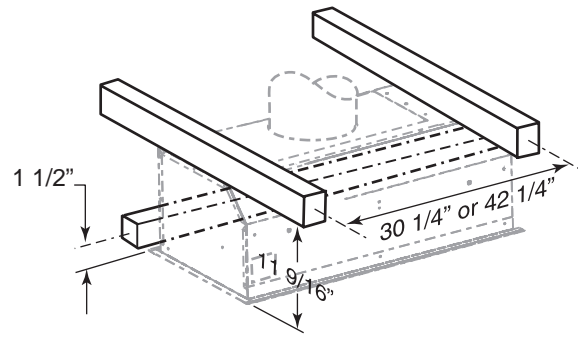

## - PIK33 AND PIK45 INSERT SYSTEM - INTERIOR BLOWERS

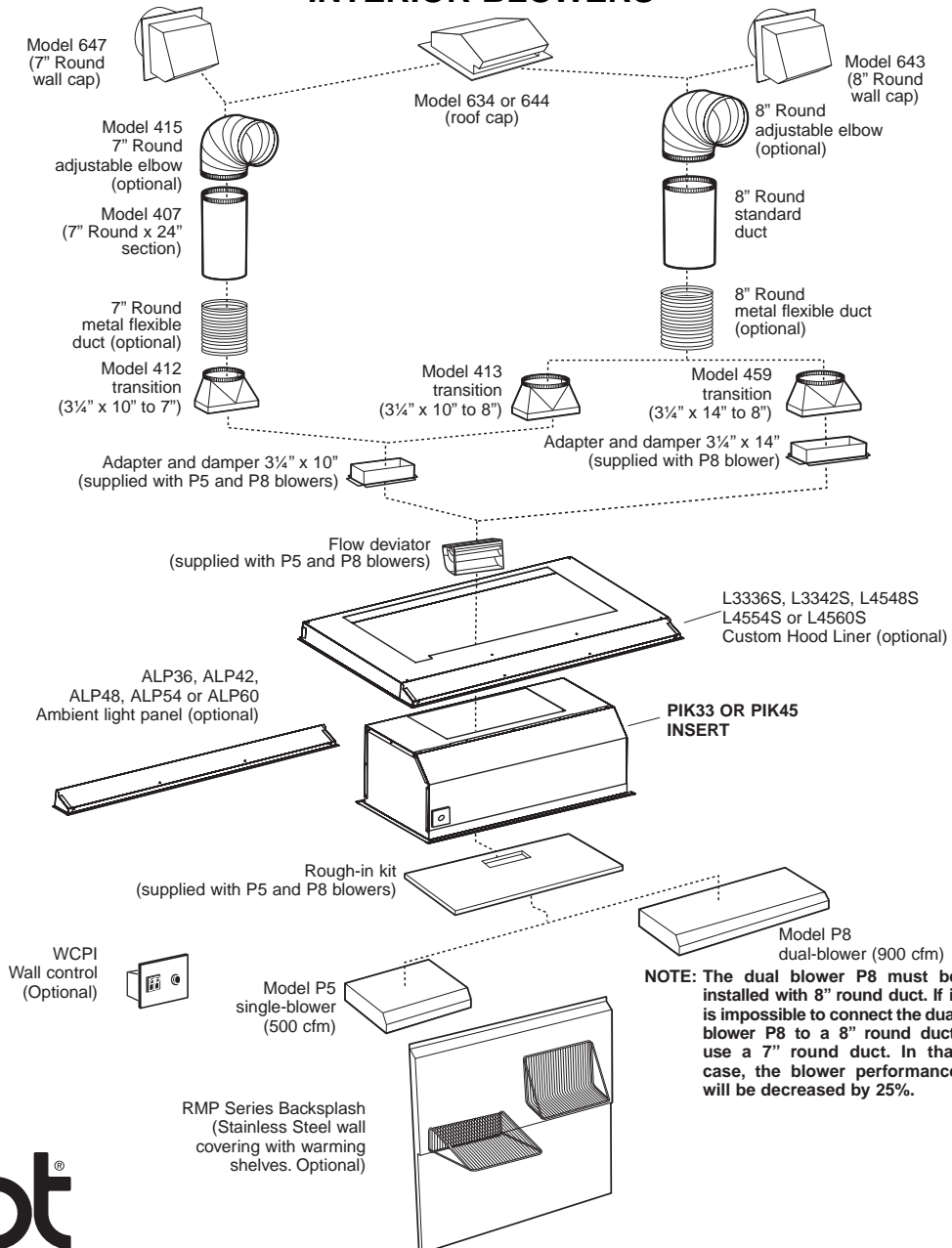

# - PIK33 AND PIK45 INSERT SYSTEM - IN-LINE AND EXTERIOR BLOWERS

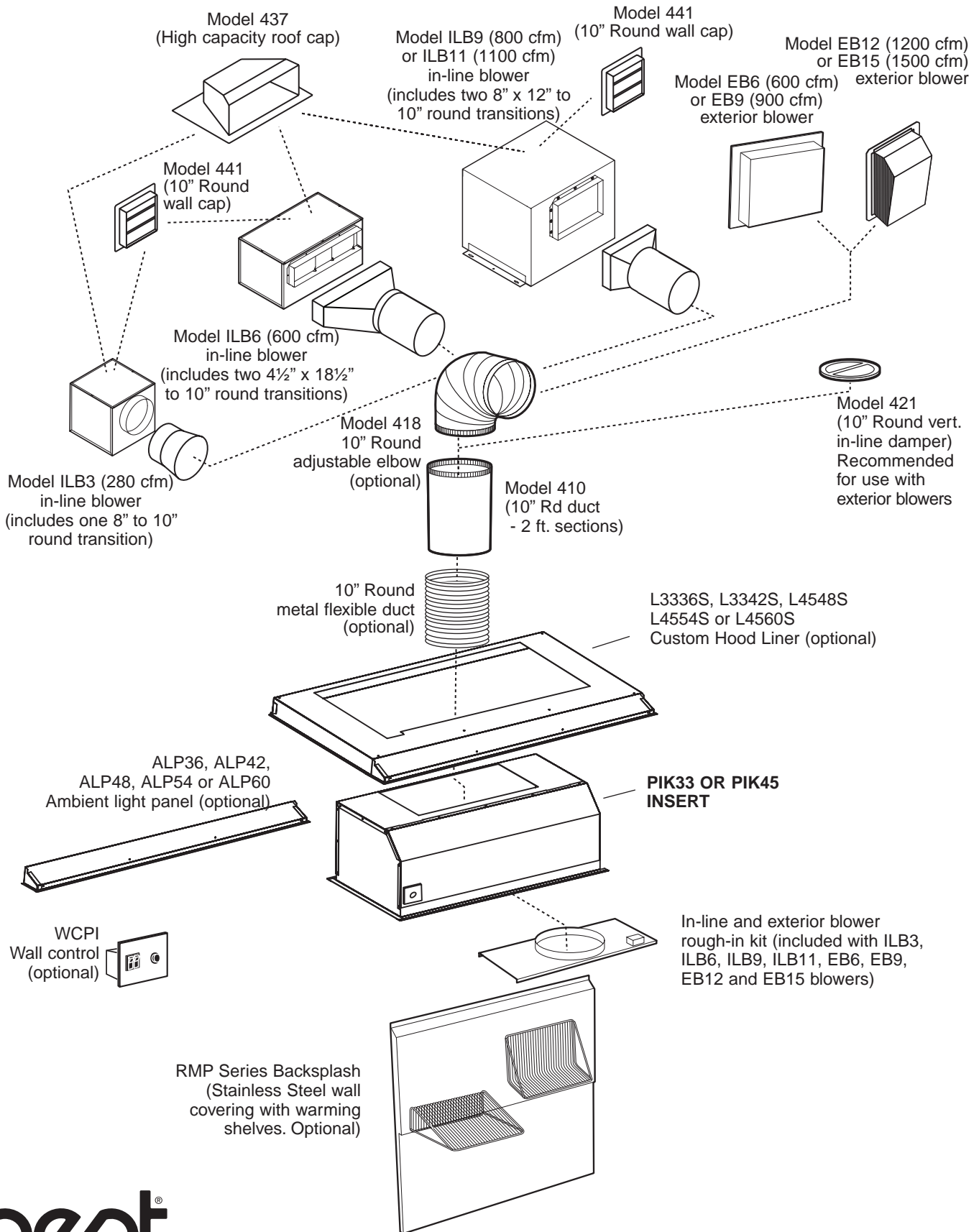

# PIK SERIES INSERTS BLOWER DUCTING POSITIONS

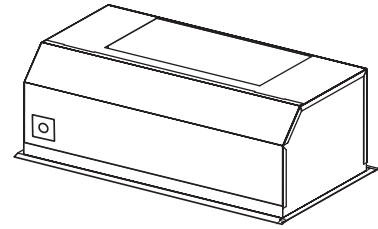

**MODEL PIK33 WITH P8 BLOWER (Vertical Outlet)**

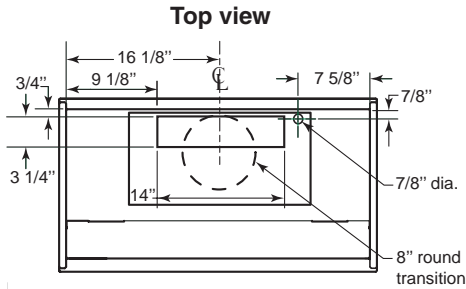

**MODEL PIK45 WITH P8 BLOWER (Vertical Outlet)**

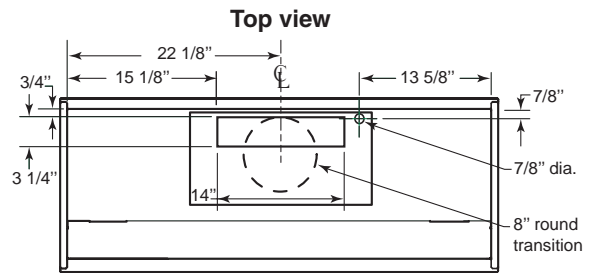

**MODEL PIK33 WITH P5 BLOWER (Vertical Outlet)**

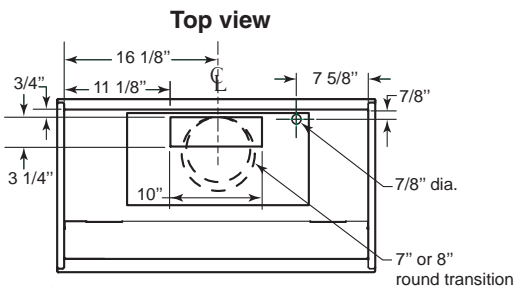

**MODEL PIK45 WITH P5 BLOWER (Vertical Outlet)**

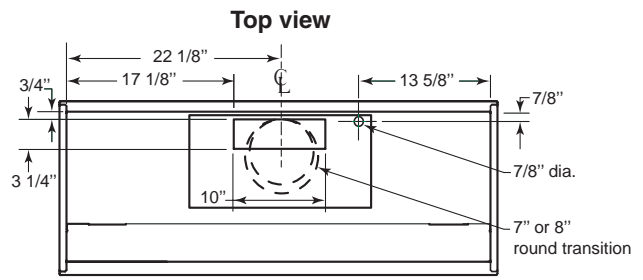

**MODEL PIK33 WITH EB6, EB9, EB12 OR EB15 BLOWER (Vertical Outlet)**

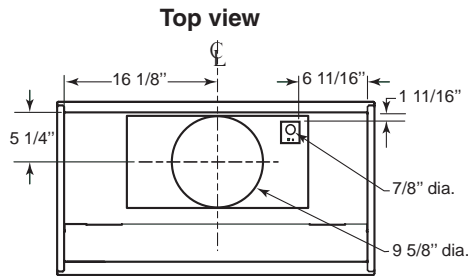

**MODEL PIK45 WITH EB6, EB9, EB12 OR EB15 BLOWER (Vertical Outlet)**

